

VERANDA SUNBLIND

VZ080-ZIP

Article number 050680

DOORS

ROLLER
SHUTTERS

SUN PROTECTION

HAROL®

ALWAYS READ THE INSTALLATION INSTRUCTIONS BEFORE ASSEMBLING!!!

TABLE OF CONTENTS

1. GENERAL	4
2. FITTING TYPES	4
2.1. MT1 - MT4	4
2.2. MT5 - MT6	4
2.3. MT7 - MT8	5
2.4. MT9 - MT10	5
3. PROFILES	5
3.1. The separable guide rails	5
3.2. The fabric roll	5
3.3. Zipper guide profile	6
3.4. The box	6
3.5. The extension pole	6
3.6. Clip-on/Clip-off	6
4. THE OTHER COMPONENTS	8
4.1. The consoles	8
4.3. Guide rail covers	8
4.4. The tensioning system	8
4.5. Connectors	8
4.6. Mounting of the guide rails	8
4.7. Fixing on the wall	9
4.8. Coupling of 2 lateral guides	10
5. CONTROL	11
5.1. Motor-controlled operation	11
6. TECHNICAL OPTIONS	12
7. MEASURING AND ASSEMBLING	13
7.1. Guidelines for correct measuring	13
7.2. The assembly	13
8. FABRICS	13
9. BLACKOUT	15
10. WEIGHT	15
11. FRAME COLOUR	15
12. FASTENING MATERIALS	15
13. PACKAGING	16
14. USE AND MAINTENANCE	16
15. SAFETY	16
16. ROLL-UP TABLES	17

1. GENERAL

- The VZ080 veranda sunblind is designed to control to a considerable extent the penetration of sunlight in a room, which can cause uncomfortably high levels of light and heat. The fabric of the blind is protected and rolled up in a box which is closed by the extension pole when the screen is completely retracted. The box is fixed to the guide rails.
- The fabric is kept at a safe distance from the veranda roof by the position of the guide rails and a cable spring system that keeps the fabric under constant tension.
- The system is so designed as to enable any minor seating tolerances in the roof sections to be easily taken up. The entire system is made of non-corroding materials.
- There are several fitting options - as standard, the VZ080 is fitted above the veranda, since the most efficient sunblind is fitted on the outside of the glazing. It can then be fixed on the veranda profiles using supports. There are several supports available for this.
- The VZ080 is provided with a zipper system that ensures the fabric remains properly tensioned at every height position of the extension pole, which prevents the fabric from pulling out of the guide rails. The sections of fabric are always finished with a zipper on the left and right, of which the thicker side slides into a plastic zipper profile. This is placed in a separable aluminium guide profile.
- The VZ080 consists of:
 - A box with an easily removable fabric roll with motor control.
 - A polyester fabric with zipper that is rolled up in the box.
 - Separable guide rails to reach the zipper guide smoothly.
 - An extension pole with spring to keep the fabric tensioned.

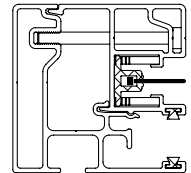

2. FITTING TYPES

The VZ080 can be fitted in various ways. Here we will describe the various fitting types. The choice of these fitting types has an effect on such things as the technical possibilities, drainage holes and so on.

2.1. MT1 - MT4

- Outdoor fitting
- Sunblind viewed along outside
- Fabric hangs outside
- Zipper at window side
- Drainage holes in extension pole and possibly in box
- Alu side of the fabric points to the sun for Soltis 86 and 92
- Grey film is on the window side for blackout fabric

ATTENTION:

In the case of fitting types 2 and 4, dirt can easily get into the box with the fabric. Additional periodic cleaning is required here.

Additional drainage holes are also provided in the box.

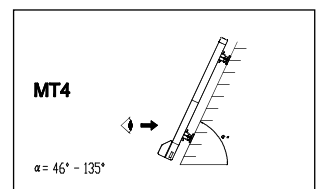
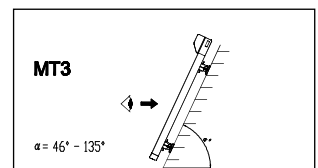
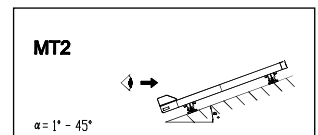
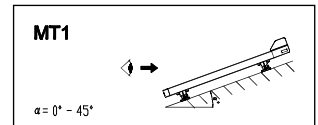

2.2. MT5 - MT6

- Indoor fitting
- Sunblind viewed along inside
- Fabric hangs inside
- Zipper at window side
- No drainage holes in extension pole and box.
- Alu side of the fabric points to the floor for Soltis 86 and 92.
- Grey film is on the window side for blackout fabric.

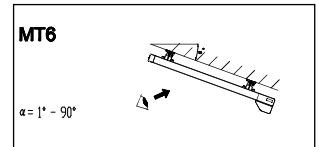
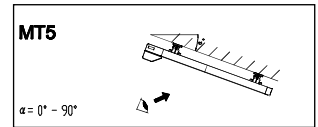

2.3. MT7 - MT8

- Outdoor fitting
- Viewed along outside
- Fabric hangs outside
- Zipper at window side
- Alu side of the fabric points to the sun for Soltis 86 or 92
- Grey film is on the window side for B-92 Blackout fabric

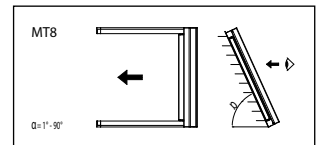
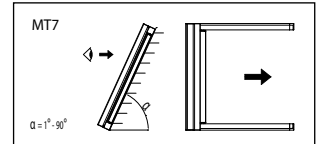

2.4. MT9 - MT10

- Indoor fitting
- Viewed along inside
- Fabric hangs inside
- Zipper at window side
- Alu side of the fabric points to the floor for Soltis 86 and 92.
- Grey film is on the window side for B-92 Blackout fabric

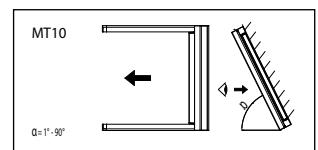
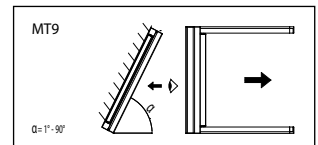

Attention!
With MT 7/8/9/10, dirt can get in the guide rail.
The motor is always at the top of the box
To prevent damage to the lower side guide, We
consider a placement for a sliding window unsuitable.

3. PROFILES

3.1. The separable guide rails

- Material: extruded aluminium with powder coating
- Wall thickness: 1.5 mm
- Colour: choice from RAL colour range
- Two types:
 - Lateral guides: installed on outer sides, with a rail slot on one side only.
 - Coupling guides: installed in the middle, with a rail slot on either side.
- The profiles have a hollow chamber into which the support pins of the side caps fit.
- Aluminium end caps coated to match the frame.

3.2. The fabric roll

- Material: circular tube made of galvanised steel, with a groove for attaching the fabric.
- Function: rolling the fabric up and down
- Diameter: Ø67 x 1.25 mm.

Fig. 1

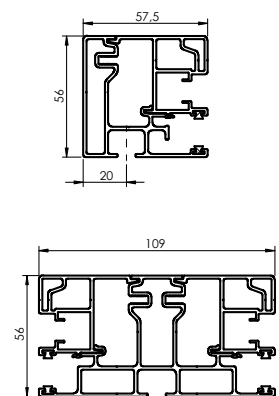

Fig. 2

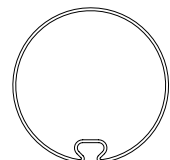

Figure 1:
Guide rails

Figure 2:
Fabric roll

Figure 3:

Zipper guide profile with springs

3.3. Zipper guide profile

- Material: extruded PVC clip profile
- Function: Absorption of the zipper profile on the fabric to keep the fabric tensioned with the aid of stainless steel springs.

Fig. 3

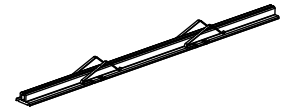

Figure 4:

Box

3.4. The box

- Material: extruded aluminium with powder coating
- Wall thickness: 2 mm
- Dimensions: 134 mm x 118 mm
- Colour: choice from RAL colour range
- Consists of two sections:
 - a removable chamfered upper section or cover;
 - a fixed lower section.
- A fabric guide profile is attached to the fixed section, which guides the fabric out of the box.
- A brush is secreted in the cover.

Fig. 4

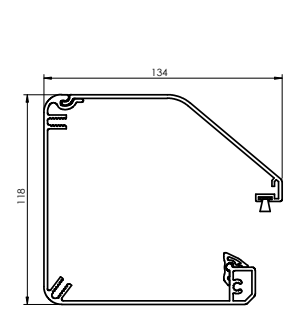

3.5. The extension pole

- Material: extruded aluminium with powder coating
- Wall thickness: Basic section 2 mm
- Locking profile 1.5 mm
- Colour: choice from RAL colour range
- Function:
 - The basic section is provided with a groove to which the fabric can be attached.
 - A locking profile: is clipped on to the basic section.
 - Runs along the grooves in the lateral guides via specially designed sliding blocks.
- Optionally, a rubber (A125) or brush (A947) can be fitted to the front of the extension pole. In certain fitting situations, these can also be fitted to the underside of the extension pole, during installation.

Fig. 5

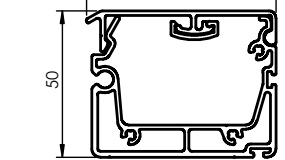

Figure 5:

Extension pole

3.6. Clip-on/Clip-off

- Material: extruded PVC clip profile
- Function:
 - attaching the fabric in the fabric slot without the use of screws, so that the fabric can be removed from the front instead of sliding it sideways.
- Diameter of the fabric retainer to be combined: Ø3 mm.
- Advantage: quick and easy fabric changing.

Fig. 6

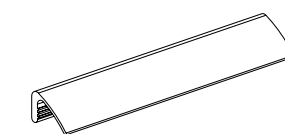

Figure 6:

Clip-on/Clip-off profile

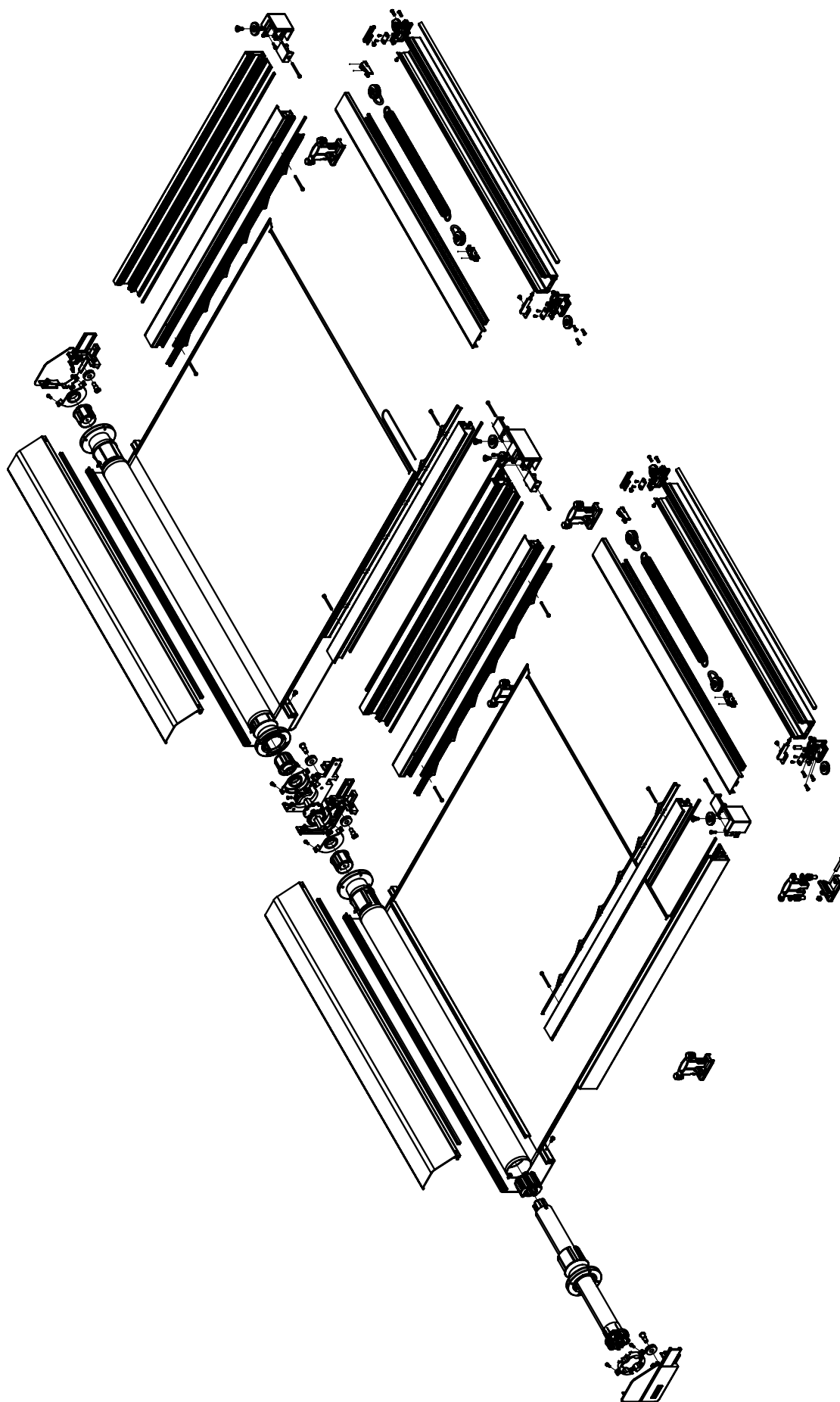

Figure 1: Exploded view VZ080

4. THE OTHER COMPONENTS

4.1. The consoles

- Material: high-pressure-cast aluminium with powder coating.
- Colour: colour of frame
- Dimensions: 134 x 118 mm
- There are 2 types of consoles: side consoles and coupling consoles

Figure 7a:

Side consoles

Fig. 7a Side console

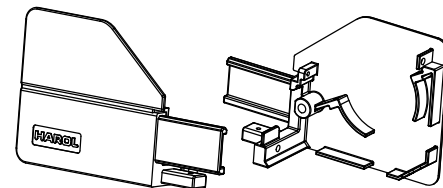

4.2. The sliding blocks

- Material: Plastic injection moulding
- Colour: black
- Function:
 - Connection of extension pole and guide rails, fitted with a sliding surface that meshes into the running surface of the guide rail.
 - These are screwed into the left and right of the end of the extension pole.

Figure 7b:

Coupling consoles

Fig. 7b Coupling console

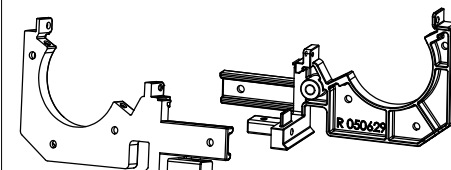

4.3. Guide rail covers

- Material: high-pressure-cast aluminium with powder coating.
- Colour: colour of frame
- Function:
 - To cover the guide rail
 - Turn-over wheel cord

Figure 8a:

Sliding block

Figure 8b:

Sliding block with track wheel

Fig. 8a Sliding block

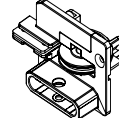
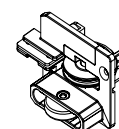

Fig. 8b Sliding block + track wheel



4.4. The tensioning system

- Material: the castors, axles, etc. are made of non-corroding materials.
- Function: fabric and extension pole can be constantly kept under tension via a spring, castors and a cord of Ø2 mm.
- This keeps the fabric at a certain distance from the glass roof when unrolled, so that there is a ventilation space between the sunblind and the glass roof (elimination of accumulated heat).

Figure 9:

Cover for guide rail

Fig. 9

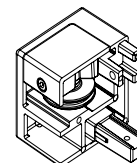

4.5. Connectors

- Material: Corrosion-free material
- Function: Pairing 2 fabric parts
- Adjustable into 8 steps

Figure 10:

Connectors

Fig. 10 Connectors

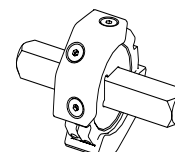

4.6. Mounting of the guide rails

S: Standard aluminium bracket

- Material: aluminium version, with powder coating adapted to the colour of the frame.
- Function:

The attachment system is in two parts:

 - The upper part: attached to the bottom of the lateral and central guides.
 - The lower part, comes in two versions:

Figure 11:

Standard fixing support

Fig. 11: Low support A - Alu

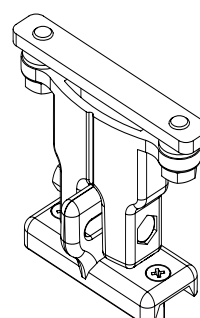

- **A: Low bracket A**
 - for veranda roof profiles with glass above and wooden pergola and veranda systems.
 - is screwed into the wood or into the groove at the top of the profiles into which the rubber seal is fixed. (fitting A)
- **B: High bracket B**
 - for veranda profiles with the glass beneath and screwed into the veranda roof profile with two bolts. (fitting B)
 - The upper and lower parts can be adjusted laterally to one another. This allows small positioning deviations between guide profile and veranda profile to be absorbed.

Fig. 12: High support B - Alu

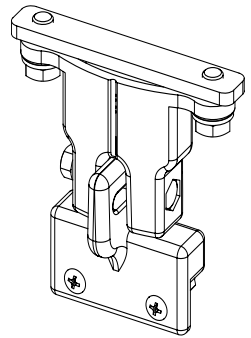

Figure 12:

Standard fixing support

Z: without brackets

- Attention: the fabric will always droop a little but must never touch the glass.

Fig. 13

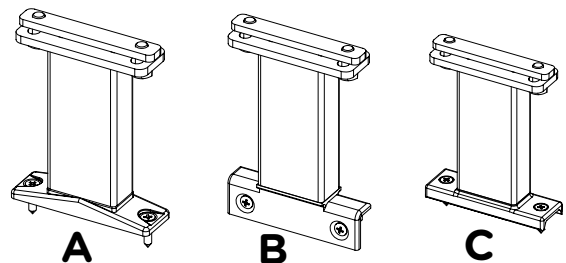

A279: Extended supports

- A: Low support A**
- B: High support B**
- C: Low support C**

- The clearance between the guide rail and the glass profiles can be increased by means of extended supports.
- When doing this, take into account the fact that the veranda profiles, when using extended supports, will be subject to heavier loads.
- For this reason, they can only be used when there is no danger of them twisting. If required, each guide rail must be supported.
- The extended supports are available in lengths of 120 mm, 200 mm, 300 mm or 400 mm.
- The maximum permitted distance between two attachment points of a guide rail is 1600 mm.

Figure 13:

Extended supports

A168: Pre-drill guide rails along the bottom.

A167: Pre-drill guide rails in the side.

- If you choose to pre-drill the guide rails, no supports will be provided.
- Holes of Ø5 mm will be provided, at max. 500 mm distance apart.

Fig. 14

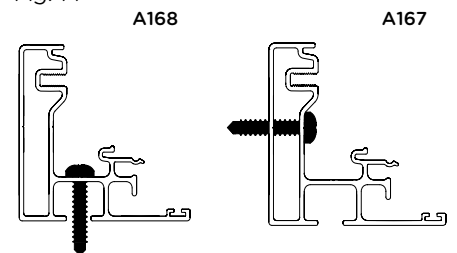

Figure 14:

Pre-drilled guide rails

4.7. Fixing on the wall

Additional fitting options:

- If fitting methods A or B are not possible, an option is to fix against a wall. There are 3 standardised L-profiles for this that can be provided in any desired length. (Always to be used with flat supports A)
- Available in the following sizes:
 - Type L1 = 50 x 30 x 3 mm
 - Type L2 = 100 x 50 x 3 mm
 - Type L3 = 130 x 50 x 5 mm

Fig. 15

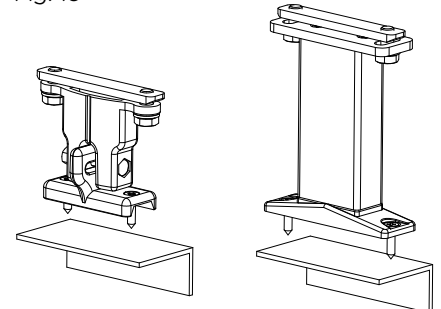

Figure 15:

Fixing on the wall

4.8. Coupling of 2 lateral guides

For coupling two veranda sunblinds, the coupling components can be used.

There are two coupling components in aluminium:

- The coupling plate:
 - The plate is placed underneath the 2 lateral guides. In the plate, there are 4 holes provided for the screws. The screws are driven into the groove of the guide rails (2 per guide rail) to secure the plate.
 - In the middle of the plate, there are 3 holes provided for fixing an extended support.

Fig. 16:

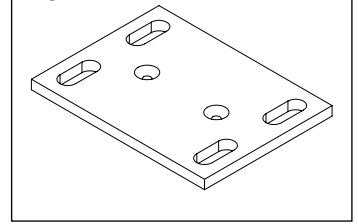

Figure 16:

Coupling plate

- The coupling angle:
 - The angle is placed underneath the 2 lateral guides. The horizontal surface, which is placed underneath the guide rails, has 2 holes for the screws. The screws are driven into the grooves of the guide rails (1 per guide rail) to secure the angle.
 - The vertical part has 1 hole for fixing the A or B support.

Fig. 17:

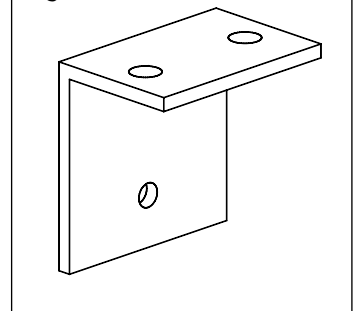

Figure 17:

Coupling angle

- Coupling duo set (Option A269):
 - Consists of:
 - The coupling plate and coupling angle with the requisite screws, nuts and washers.
 - Function:
 - When using an extended support in the middle, the profile of the elevated support is directly fixed to the coupling plate. In that case, the upper part of the extended support will not be used. (Fig. 20)
 - If the standard support is placed in the middle, the upper part of the support should be replaced by the coupling angle. (Fig. 19)
 - If the support is placed left or right on the guide rail, the coupling will be done independently of the support, by mounting the coupling plate behind the support. (Fig. 18)

Fig. 18:

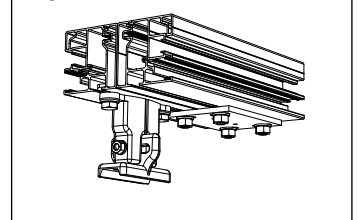

Figure 18:

Positioning support under left or right guide rail

Fig. 19:

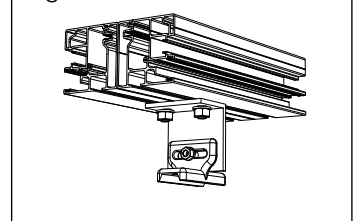

Figure 19:

Positioning standard support in the middle

DROP	NUMBER OF SUPPORTS PER GUIDE RAIL
1600	2
3200	3
3500	4

Figure 20:

Positioning extended support in the middle

Fig. 20:

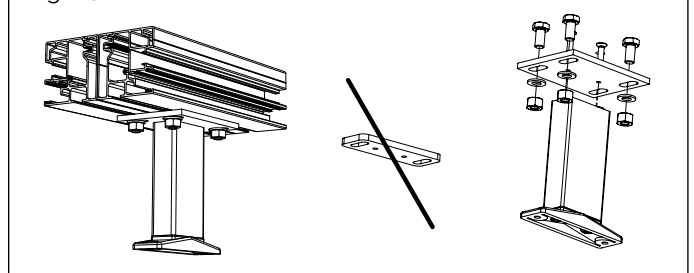

5. CONTROL

5.1. Motor-controlled operation

Drive via tubular motors: 230 Volt (50 Hz):

- Fitted far left and/or far right as required
- The standard motor is the Sunea IO motor, without push buttons and controlled with an IO transmitter.
 - IO transmitter.
 - 5m electric cable.
- Option:
 - without IO wall transmitter.
 - electric cable 10m instead of 5m.
 - other types of motors : Orea RTS - Orea WT

Prod. Type	MOTORTYPE	OPTION	SURCHARGE	CABLE LENGTHS		
				3M	5M	10M
VZ080	Sunea IO	A1281	-	-	S	X
	Orea RTS	A1076	-	-	S	X*
	Orea WT	A2619	Minus price	S	X	X**

S: Standard X: Option

*: Without RTS wall transmitter

**: Without surface mounted switch

Figure 21: Exits (cabling)

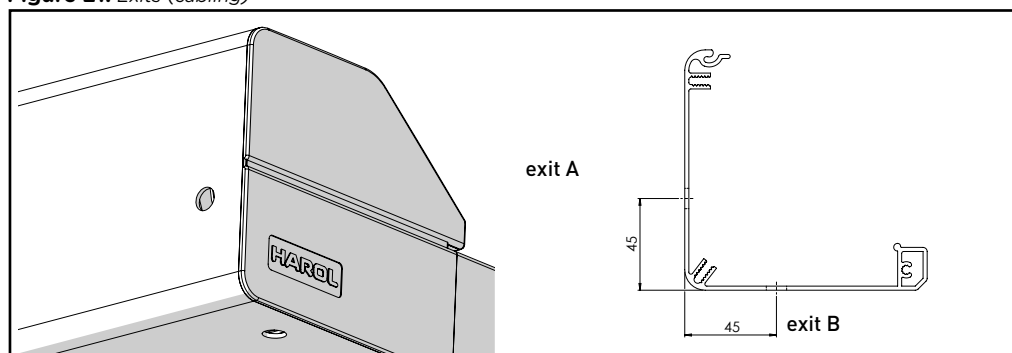

5.2. Automation

- Accessories (For this, see the Harol Domotics folder):
 - Relay boxes
 - Wind-and-solar control
 - Time switches
 - Remote control
 -

6. TECHNICAL OPTIONS

- Minimum width per element: **0.85 m**
- Maximum width per element: **3 m**
- Maximum drop: **3.5 m**
- Maximum surface area per fabric: **10.5 m²**

If the composite ordered width is less than 6 m, everything will be supplied in a single box part. If the width is greater than 6 m, two separate parts will be supplied, to be linked to each other on site.

When choosing option A1625, however, the box parts can be supplied separately, so that the sun screen may be delivered more easily to the location where it is to be installed.

Type		Maximum range in metres													Maximum surface area	Number of elements	Number of motors	
		1	1.7	2	2.55	3	3.4	4	5	6	7.5	8	9	10				
Type 1	1 element	1 part													10.5 m ²	1	1	
Type 2	2 elements		2 parts												17.5 m ²	2	1	2 up to 6m
Type 3	3 elements				3 parts										26.25 m ²	3	2	
Type 4	4 elements						4 parts								35 m ²	4	2	

Table 1: Technical possibilities



(MT7 - MT10 not for coupling)

See roll-up tables page 17 for detailed dimensions per fabric type and fitting type.

If a second motor is built into the second section of a Type 2, then the maximum width of 5000mm may be exceeded, up to a maximum width of 6000mm.

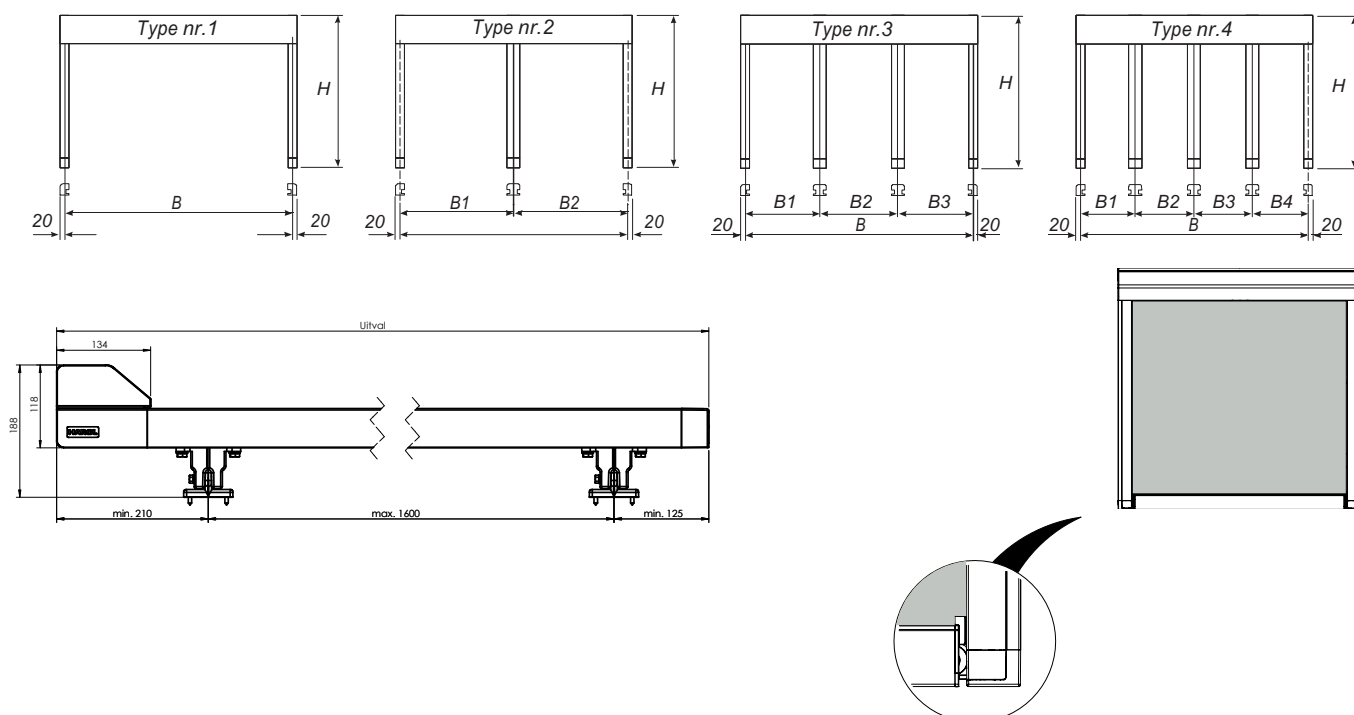

Figure 22: Measuring and assembling

7. MEASURING AND ASSEMBLING

7.1. Guidelines for correct measuring

- The total width = centre of veranda profile to centre of veranda profile. The outside of the box is always 40 mm (2 x 20 mm) wider than the centre of the guide rails or the centre of the mounting brackets.
- The drop: measured from the back of the box at the top against the wall to the front of the guide rail, including the cover.
- The final position of the extension pole can be set flush with the end of the cover of the guide rail.

Please note: the width of the box is always 40 mm more than the order width. (see fig. 20 page 11)

7.2. The assembly

- Please note: always ensure a right-angled fitting. If the assembly is not right-angled, this will greatly increase the risk of wrinkles in the fabric.
- See overview of the fitting supports (point 4.5, p. 7).
- Attention: The maximum distance between two attachment points of a guide rail is 1600 mm.
- The maximum overhang is 500 mm.



Make sure the box and extension pole can always be opened, to ensure that the mechanical parts inside are accessible at all times. If this rule is not followed, Harol cannot be held responsible for the cost of demolition work!

8. FABRICS

Choice of different types of fabric:

	SOLTIS 86	SOLTIS 92	BLACKOUT B92
basic material	Polyester	Polyester	Polyester
weight (g/m ²)	approx. 380	approx. 420	approx. 650
thickness (mm)	approx. 0.43	approx. 0.45	approx. 0.60
fire class	M1	M1	M2
roll width (mm)	1770 / 2670	1770 / 2670	1700
strip direction	Horizontal	Horizontal	Horizontal
opening factor	14%	3 to 4%	0%

Table 2:

Technical data of the fabrics

1. Soltis 86 and Soltis 92

- Transparent and refractive fabric.
- Woven from polyester thread, stretched under great tension and secured with a plastisol layer.
- Varnished on two sides -> excellent protection against UV rays.
- High tear strength without additional reinforcement.
- Durable and dirt repellent.
- Exceptional dimensional stability when used between -30 °C and +70 °C.
- Sunblinds with a drop of -> 2670 mm are fitted with a horizontal weld seam!
- With two-tone fabrics, the Alu side is always on the outside or on the garden side with fitting types 1-4; with fitting types 5-6 always towards the floor.
- Minimum slope angle 8°, if there is a chance of light rain on the fabric.

2. Blackout fabric B92

- Opaque and light-blocking fabric.
- Woven from polyester thread, stretched under great tension and secured with a plastisol layer.
- Provided with a light-blocking PVC coating on one side (window side).
- Wind can cause the bottom lath and fabric to lift up, and as a result it is not possible to guarantee that light is blocked 100%.
- Sunblinds with a drop of -> 1700 mm are fitted with a horizontal weld seam!
- Minimum slope angle 15°, if there is a chance of light rain on the fabric.

3. Finish

Zippers are placed on the sides of each fabric, and with correctly fitted guide rails, the zippers ensure that the fabric is taut in any height position of the extension pole, thanks to the tension between the zipper and the guide rails.

A crackling sound may be heard when rolling up the blind, caused by the fabric being under tension. (cause: the expulsion of the air between the surfaces of the fabric). Along the side of the fabric, where the zipper is inserted, wrinkles will form. This phenomenon is caused by the different thicknesses of the material and their expansion factors.

For the **blackout blinds**, the zippers are welded to the Soltis side of the fabric, not to the blackout foil side, in order to obtain better adhesion and less movement of the fabric. As a result, it is possible that a piece of fabric from the zipper tape is visible during wind pressure or with an oblique view of the guide rail, but this is of minor importance compared to the view or the tautness of the fabric (wave reduction).

With the Soltis 86/92 fabrics, the zippers are always on the back of the fabric - or in other words, on the side of the window.

In addition to the options for applying letters or logos to the fabric, there is also the option to invert the fabric colour or fabric side on the sunblind (A490) - see illustration.

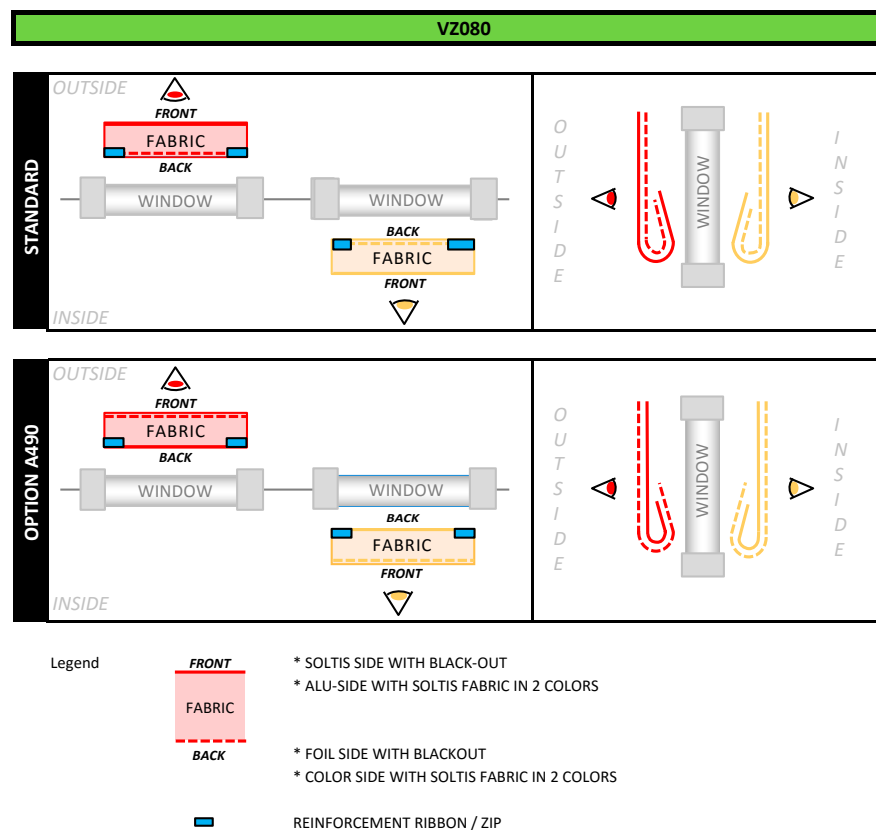

Figure 23:
Visualisation option
A490

9. BLACKOUT

The VZ080 can be used to darken a room, i.e. shield it from the outdoor light in order to give presentations or projections, but it is not such that photos can be developed, in other words, it is not 100% blackout.

To achieve a proper blackout, the following points need to be taken into account:

- It is only possible by using a **blackout fabric**.
- The spaces between the guide rails, the box, the wall and the window frame must be carefully sealed (with, for example, silicones, strips, or the like).
- In the event of using a **blackout fabric**, you can opt for a rubber (A125) or brush (A947) in the bottom lath. This is always placed at the front; if desired, this can be re-adhered to the bottom of the extension pole on site. The rubber or brush of the bottom lath should then touch the window sill/wall correctly. The extension pole must keep the fabric taut, which is not possible if the rubber is completely resting on the window sill.
- Wind action can cause the bottom lath to waft up, and as a result a gap may occur.
- Account should be taken of a small gap between the extension pole and the guide rail.
- Option A2426 - placing an extra angled profile (30x20x2) for the extension pole against the wall reduces even more the chance of a chink of light appearing.

10. WEIGHT

The approximate weight of the box based on a fabric roll of Ø67, an LT-50 motor and a Soltis fabric, can be found in Table 4a below; the weight of two standard lateral guides can be found in Table 4b.

For a VZ080 with a width of 1.5 metres and a height of 1 metre, the total weight is approx. 20.5 kg.

BOX		2 LATERAL GUIDES		COUPLING GUIDE	
LENGTH	WEIGHT	LENGTH	WEIGHT	LENGTH	WEIGHT
1.0 m	Approx. 13 kg	0.5 m	Approx. 2 kg	0.5 m	Approx. 2 kg
1.5 m	Approx. 17 kg	1.0 m	Approx. 4 kg	1.0 m	Approx. 3.5 kg
2.0 m	Approx. 21 kg	1.5 m	Approx. 6 kg	1.5 m	Approx. 5.5 kg
2.5 m	Approx. 24 kg	2.0 m	Approx. 8,5 kg	2.0 m	Approx. 7.5 kg
3.0 m	Approx. 28 kg	2.5 m	Approx. 10,5 kg	2.5 m	Approx. 9 kg
		3.0 m	Approx. 12,5 kg	3.0 m	Approx. 11 kg
		3.5 m	Approx. 14,5 kg	3.5 m	Approx. 13 kg

Table 3:

Weights of the box, 2 lateral guides and coupling guide

11. FRAME COLOUR

According to RAL colour range.

12. FASTENING MATERIALS

All fastening materials are of stainless steel and accessories are always included.

13. PACKAGING

All sunblinds are fully packed in solid cardboard boxes.

14. USE AND MAINTENANCE

Proper use and maintenance greatly increase the lifetime of the sunblind.

- Do not use the blind as a rain or wind screen.
- Regular maintenance prevents unnecessary wear and operational problems.
- Cleaning the frame: use soft water instead of aggressive substances, which may affect the coatings and protective layers.
- Cleaning the fabric: dry with a slightly stiffer brush.
- With stubborn stains: clean with a warm water and light detergent solution, rinse with copious amounts of clean water.
- Always let the fabric dry fully before rolling it up (even after an unexpected rain shower).
- It is recommended to offer the end customer a maintenance contract for this product.

15. SAFETY

For the safety of the end user, the sunblind must be installed strictly in accordance with the fitting instructions.

16. ROLL-UP TABLES

Below you will find the possible dimensions for a VZ080 Type 1 (single screen). For VZ080 Type 2, Type 3 or Type 4 there are two or more fabrics, each of which can be found in the table below.

SOLTIS 86, 92			FITTING TYPE 1 - 3 - 5 - 7 - 8 - 9 - 10												FITTING TYPE 2 - 4 - 6																																																																																																																																																																																																																																																																																																																																																																																																																																																																																																																																																																																																																																																																																																																																																																																																																																																																																																																																																																																																																																																																																																																																																																																																																																																																																																																																																
			1100	1250	1500	1750	2000	2250	2500	2750	3000	1100			1250	1500	1750	2000	2250	2500	2750	3000																																																																																																																																																																																																																																																																																																																																																																																																																																																																																																																																																																																																																																																																																																																																																																																																																																																																																																																																																																																																																																																																																																																																																																																																																																																																																																																																									
	height	500																																																																																																																																																																																																																																																																																																																																																																																																																																																																																																																																																																																																																																																																																																																																																																																																																																																																																																																																																																																																																																																																																																																																																																																																																																																																																																																																																													

SOLTIS B92			FITTING TYPE 1 - 3 - 5 - 7 - 8 - 9 - 10												FITTING TYPE 2 - 4 - 6									
	height		1100	1250	1500	1750	2000	2250	2500	2750	3000			1100	1250	1500	1750	2000	2250	2500	2750	3000		
		500												500										
		750											750											
		1000											1000											
		1250											1250											
		1500											1500											
		1750											1750											
		2000											2000											
		2250											2250											
		2500											2500											
		2750											2750											
		3000											3000											
		3250											3250											
		3500											3500											

TECHNICAL DATA VERANDA SUNBLIND VZ080

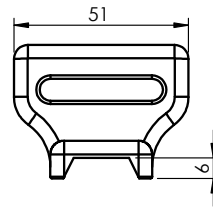
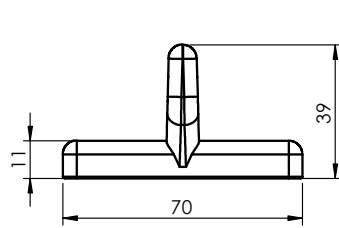

Steun Aluminium
Lage steun A

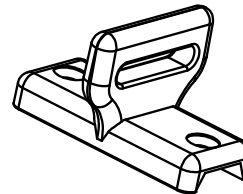
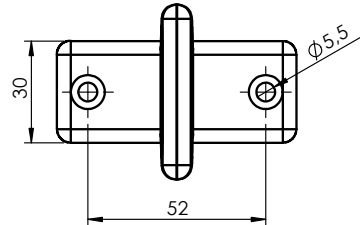
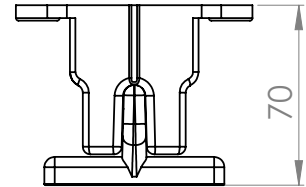

Low support A - Alu

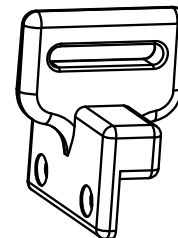
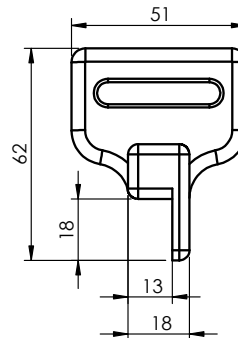
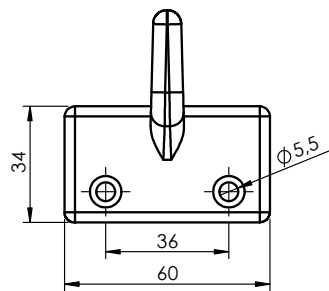

High support B - Alu

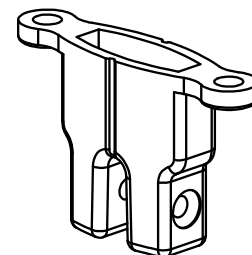
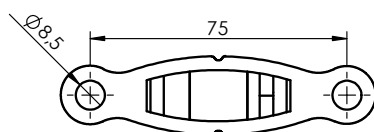
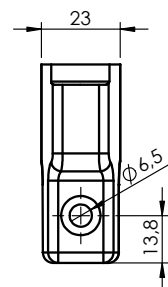
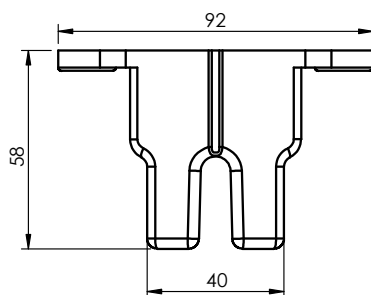

Top side of support - Alu

Alu

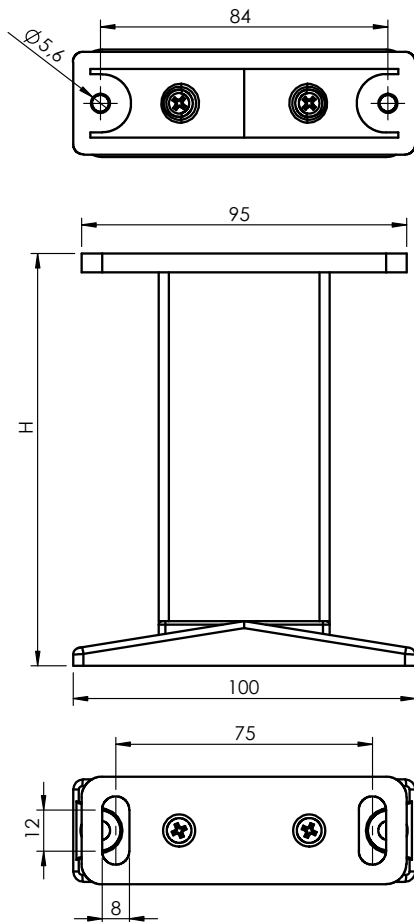

Extended support A - Alu

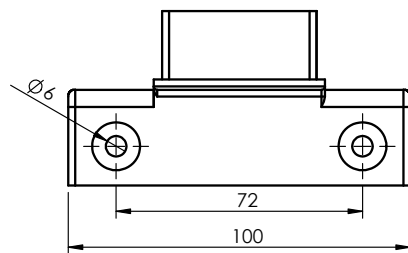
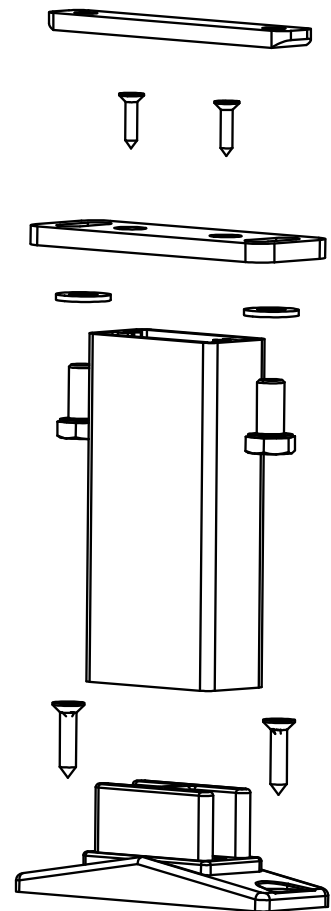
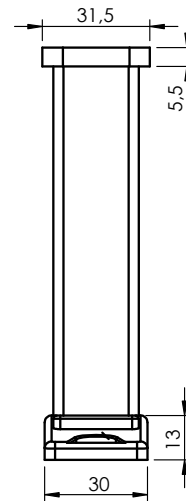

Foot of extended support B - Alu

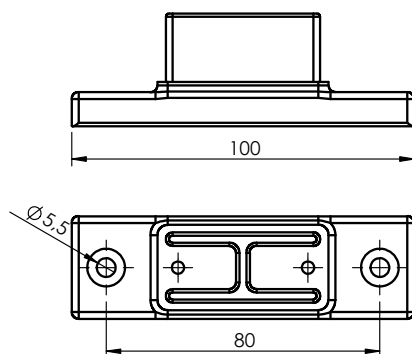
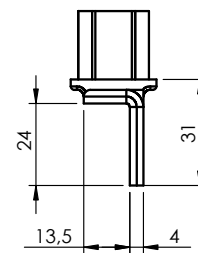

Foot of extended support C - Alu

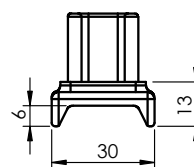

ORDER FORM FOR VERANDA SUNBLIND VZ080 - 2

1. Type no.:

see Table 1, page 11
Type 1 - (1 field)
Type 2 - (2 fields)
Type 3 - (3 fields)
Type 4 - (4 fields)

2. Fitting types:

see page 4
MT1, MT2, MT3, MT4, MT5, MT6, MT7, MT8, MT9 or MT10

3. Operating side:

L Left Type 1 + 2
R Right Type 1 + 2
LS Left + 2 right parts together Type 3
SR 2 left parts together + right Type 3
LR Left + right Type 3 + 4 (2)

Control is always seen from **outside** for fitting type 1 - 4
(fabric is located outside).

Control is always seen from **outside** for fitting type 5 - 6
(fabric is located inside).

Standard motor: Sunea IO

4. Exit:

A: along the rear edge
B: along the bottom
See Fig. 21, page 11

5. Dimensions:

see page 12

6. Profile fixing:

see page 12

Type	Support	Length	Description
S			Standard in aluminium
	A		Low support A
	B		High support B
A279			Extended supports
	A		Low support A
	B		High support B
	C		Low support C
		120	L = 120 mm
		200	L = 200 mm
		300	L = 300 mm
		400	L = 400 mm
Z			without supports
A 167			Pre-drilling along the side
A 168			Pre-drilling on the underside

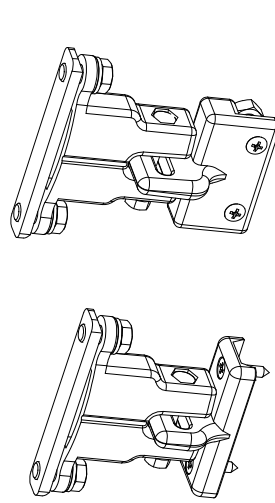

S-A

S-B

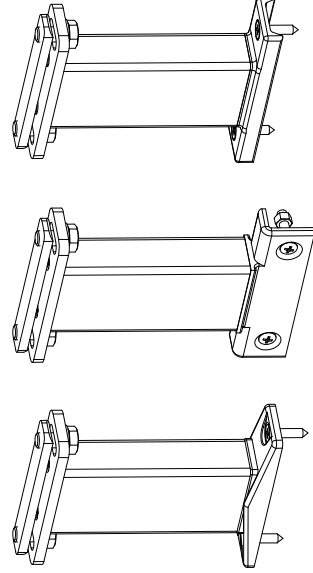

A279-A-120

A279-B-120

A279-C-120

7. Wall fixing:

see page 9

Fitting L: for against the wall
Available per piece of 100 mm, or length:
Type L1 = 50 x 30 mm
Type L2 = 100 x 50 mm
Type L3 = 130 x 50 mm

8. Frame colour:

Choice from the RAL colour range
RAL colour (indicate number)

9. Fabric:

S86 Soltis 86
S92 Soltis 92
B92 Blackout fabric

Indicate the fabric colour numbers according to the collection book.

10. Supplements

A 269 Coupling set duo 2 lateral guides
A 288 Motor cable extensible to 5 m
A 289 Motor cable extensible to 10 m
A 620 2nd motor with type 2
A 1076 Motor Orea RTS
A 2619 Motor Orea WT
A 1285 Without Smoove Origin IO transmitter
A 1117 Without Smoove Origin RTS transmitter

A576 PLR retouch pen for RAL colour
A 2372 Hirschmann plug (switch side)
A 2387 Hirschmann plug (motor side)
A 125 Rubber seal in extension pole
A947 Brush instead of rubber seal

Date: _____ HAROL reference: _____ Author: _____

CUSTOMER/INVOICE		DELIVERY ADDRESS	
Name: _____	Name: _____	Name: _____	
Address: _____	Address: _____	Address: _____	
Customer number: _____	VAT no.: _____	Mobile/Tel.: _____	Fax: _____
Mobile/Tel.: _____	Fax: _____	Desired delivery term: _____	

POSITION	QUANTITY	TYPE NO.	FITTING TYPE	OPERATING SIDE	CABLE EXIT	FINISHED MEASUREMENTS (MM)						PROFILE FIXING			WALL FIXING			FRAME COLOUR	FABRIC		SUPPLEMENTS
						B	B1	B2	B3	B4	H	TYPE	SUP-PORT	L	TYPE	LENGTH	QUAN-TITY		QUAL. LEFT	COLOUR	
1																					
2																					
3																					
4																					
5																					
6																					
		1	2	3	4	5						6			7			8	9	10	

INFORMATION:

- The operating side is always viewed from the outside.
- Please indicate all the measures in mm!
- Each order is executed according to our terms and conditions of sale!

COMMENTS:

I have taken note of the technical product descriptions and take full responsibility for the indications and sizes mentioned.

The Customer,

PRICE: _____