

# Outdoor living

terrace awning

## VERSUZ

Article number: 063576

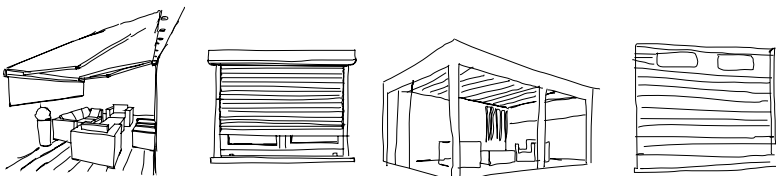

**HAROL®**

**ALWAYS READ THE INSTALLATION INSTRUCTIONS BEFORE ASSEMBLING!!!**

# TECHNICAL DATA SHEET TERRACE AWNING VERSUZ

## TABLE OF CONTENTS

1. GENERAL	4
2. FIXING METHODS	4
3. THE PROFILES	5
3.1. The separable guide rails	
3.2. The fabric roll	
3.3. Zipper guide profile	
3.4. The box	
3.5. The extension pole	
3.6. Clip-on/Clip-off	
4. MISCELLANEOUS COMPONENTS	6
4.1. The consoles	
4.2. The sliding blocks	
4.3. Guide rail covers	
4.4. The tension system	
4.5. Connectors	
4.6. Mounting of the guide rails	
4.7. Fixing on the wall	
4.8. Coupling of 2 lateral guides	
5. OPERATION	8
5.1. Motor-controlled	
5.2. Automation	
6. TECHNICAL OPTIONS	9
7. MEASURING AND ASSEMBLING	10
8. FABRICS	14
9. WEIGHT	16
10. COLOUR OF FRAME	16
11. FASTENING MATERIALS	16
12. PACKAGING	16
13. USE AND MAINTENANCE	16
14. SAFETY	17
15. ROLL-UP TABLES	17
16 APPENDIX	18
Drawings	
VERSUZ order form	

Harol reserves the right to make alterations to the product without prior notice.

# TECHNICAL DATA SHEET TERRACE AWNING VERSUZ

## 1. GENERAL

- VERSUZ sun protection is designed to control to a considerable extent the penetration of sunlight, which can cause uncomfortably high levels of light and heat. The fabric of the blind is protected and rolled up in a box which is closed by the extension pole when the screen is completely retracted. The box is attached to the wall behind, using wall brackets and fixing brackets.
- The system is designed to easily absorb any minor seating tolerances in the roof sections. Non-corroding materials have been used for the system.
- The VERSUZ has a zipper system that ensures the fabric remains correctly tensioned at every height position of the extension pole, preventing the fabric from pulling out of the guide rails. The sections of fabric are always finished with a zipper on the left and right, of which the thicker side slides into a plastic zipper profile. This is placed in a separable aluminium guide profile.
- The VERSUZ consists of:
  - A box with an easily removable fabric roll with motor control.
  - A fabric with zipper that is rolled up in the box.
  - Separable guide rails to reach the zipper guide smoothly.
  - An extension pole with spring and cords to keep the fabric tensioned, with water outlet.
  - The posts the guides rest on.
  - A crossbar at the front that bridges the horizontal connection between the posts.
  - Zipper guide and tension system.

## 2. FIXING METHODS

This type of sun protection has only one fixing method: wall mounted

The rear of the box is fitted with mounting brackets. These allow the box to be hooked onto the earlier positioned brackets.

After the box has been mounted, the posts (with crossbar) are positioned at the front and linked to the sun protection using a hinge. The posts are anchored in/on the ground.

If waterproof fabric is used and the minimal angle is respected, the water will be drained via the front rail.

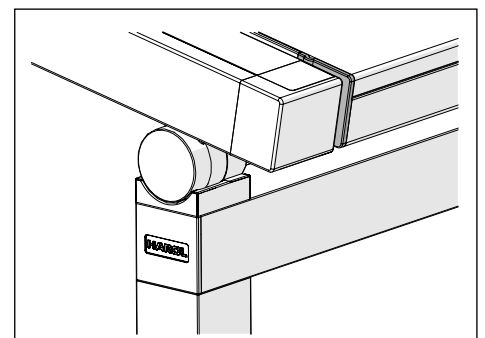
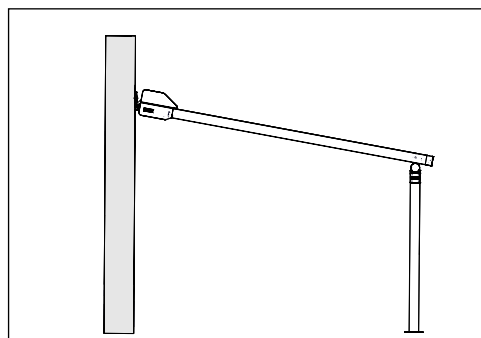
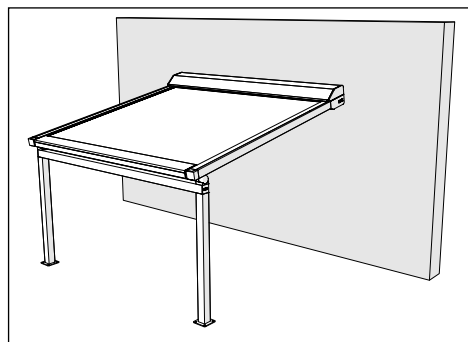

## 3. PROFILES

**Figure 1:**

Guide rails

### 3.1. The separable guide rails

- Material: extruded aluminium
- Wall thickness: 1.5 mm
- Colour: choice from RAL colour range
- Two types:
  - Lateral guides: installed on outer sides, with a rail slot on one side only.
  - Coupling guides: installed in the middle, with a rail slot on either side.
- The profiles have a hollow chamber into which the support pins of the side caps fit and through which the cords run.
- Aluminium end caps coated to match the frame.

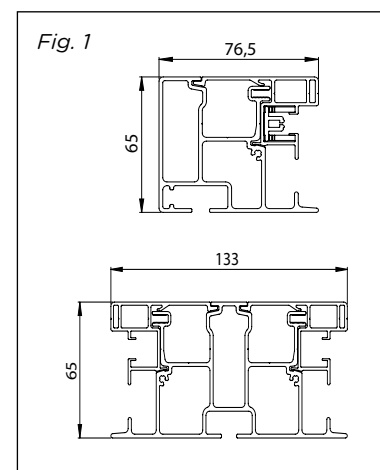
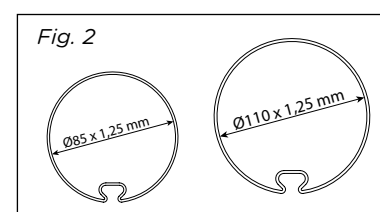

**Figure 2:**

Fabric roll

### 3.2. The fabric roll

- Material: circular tube made of galvanised steel, with a groove for attaching the fabric.
- Function: rolling the fabric up and down.

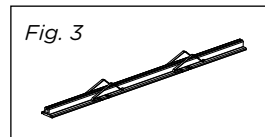

**Figure 3:**

Zipper guide profile with springs

### 3.3. Zipper guide profile

- Material: extruded PVC clip profile
- Function: The zipper profile is integrated in the fabric, as a way to keep the fabric tensioned with the aid of stainless steel springs.

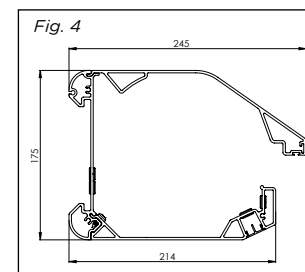

**Figure 4:**

Box

### 3.4. The box

- Material: extruded aluminium
- Wall thickness: 2 mm
- Colour: choice from RAL colour range
- Consists of two sections:
  - a removable chamfered upper section or cover;
  - a fixed lower section.
- A fabric guide profile is attached to the fixed section, which guides the fabric out of the box.
- A brush is secreted in the cover.

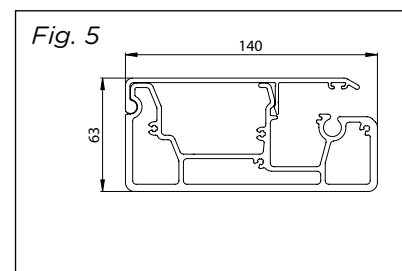

**Figure 5:**

Extension pole

### 3.5. The extension pole

- Material: extruded aluminium
- Wall thickness: basic section 4 mm
- Locking profile 1.5 mm
- Colour: choice from RAL colour range
- Function:
  - The basic section is provided with a groove to which the fabric can be attached.
  - A locking profile: is clipped on to the basic section.
  - This profile runs along the lateral guides via specially designed carriages.

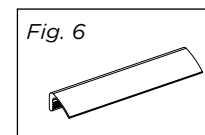

**Figure 6:**

Clip-on/Clip-off profile

### 3.6. Clip-on/Clip-off

- Material: extruded PVC clip profile
  - Function:
    - attaching the fabric in the fabric slot without the use of screws, so that the fabric can be removed from the front instead of sliding it sideways.
  - Diameter of the fabric retainer to be combined: Ø3 mm.
- Advantage: quick and easy fabric change.



**Figure 7:**

*Post*

### 3.7. The posts

- Material: extruded aluminium with powder coating
- Wall thickness: 2 mm
- Dimensions: 65 mm x 65 mm
- Colour: choice from RAL colour range
- Function:
  - The post is fitted with pins that can be used to position the crossbar.
  - A post with a flange is mounted at the footplate.

*Fig. 7*

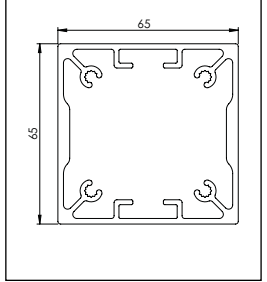

**Figure 8:**

*Crossbar*

### 3.8. The crossbar

- Material: extruded aluminium with powder coating
- Wall thickness: 2 mm
- Dimensions: 65 mm x 65 mm
- Colour: choice from RAL colour range
- The hole pattern is applied here to enable easy installation of the posts.
- These are sealed at the sides using covering caps.

*Fig. 8*

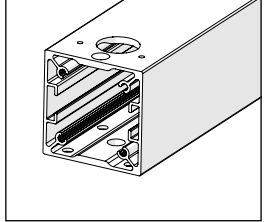

## 4. MISCELLANEOUS COMPONENTS

**Figure 9a:**

*Side consoles*

### 4.1. The consoles

- Material: high-pressure-cast aluminium with powder coating.
- Colour: colour of frame
- There are 2 types of brackets: side consoles and coupling consoles

*Fig. 9a Side console*

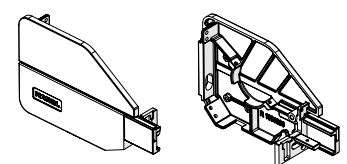

**Figure 9b:**

*Coupling consoles*

### 4.2. The carriages

- Material: Plastic injection moulding
- Colour: black.
- Function:
  - Connection between the extension pole and the guide rails, fitted with two carriage wheels that grip into the running surface of the guide rail.
  - These are screwed into the left and right of the end of the extension pole.

*Fig. 9b Coupling console*

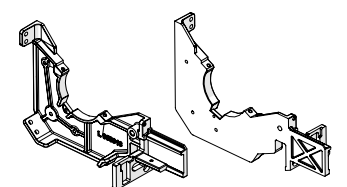

**Figure 10:**

*Carriage*

### 4.3. The tension system

- Material: the castors, axles, etc. are made of non-corroding materials.
- Function: fabric and extension pole can be constantly kept under tension via a spring, castors and a cord of Ø2.7 mm.

*Fig. 10 carriage*

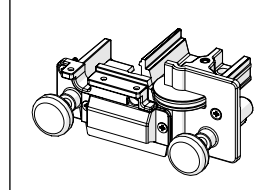

**Figure 11:**

*Guide rail cover & coupling guide*

### 4.4. Guide rail covers

- Material: high-pressure-cast aluminium with powder coating.
- Colour: colour of frame
- Function:
  - To cover the guide rail
  - Turn-over wheel cord

*Fig. 11*

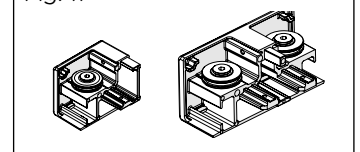

**Figure 12:**

Connectors

## 4.5. Connector

- Material: Corrosion-free material
- Function: Pairing 2 fabric parts
- Adjustable in 8 steps

Fig. 12 Connectors

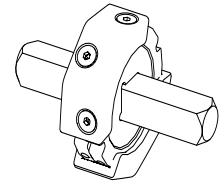

**Figure 13:**

Post

## 4.6. Footplate

- Material: Stainless steel with powder coating
- Wall thickness of footplate: 5 mm
- Footplate dimensions: 120 mm x 120 mm
- Colour: choice from RAL colour range
- The hole pattern is fitted here for anchoring into the ground.

Fig. 13 Footplate

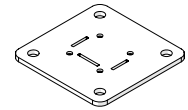

**Figure 14:**

Hinge

## 4.7. Hinges

- Material: aluminium with powder coating
- Colour: choice from RAL colour range
- Consists of two parts, joined with a screw.

Fig. 14 hinge

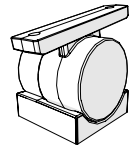

**Figure 15a:**

Wall bracket part 1

## 4.8. Wall bracket part 1

- Material: aluminium with powder coating
- Colour: choice from RAL colour range

Fig. 15a wall bracket part 1

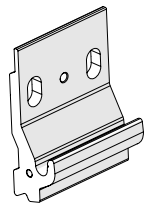

**Figure 15b:**

Wall bracket part 2

## 4.9. Wall bracket part 2

- Material: stainless steel bend piece with spindle and circlips

Fig. 15b wall bracket part 2

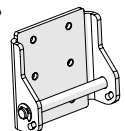

**Figure 16:**

connecting bracket for post

## 4.10. Post coupling bracket

- Material: stainless steel bend piece with two clamping elements and socket screws.

Fig. 16 connecting bracket for post

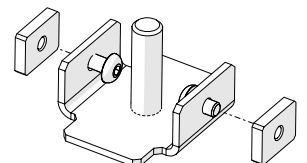

## 5. CONTROL

### 5.1. Motor-controlled operation

Drive via tubular motors: 230 Volt (50 Hz):

- Fitted far left and/or far right as required
- Standard:
  - motor with built-in IO receiver (Sunea IO).
    - 5 m electric cable - optional 10 m electric cable
    - with IO wall transmitter - optionally without IO wall transmitter
  - Fitted far left and/or far right as required
- Optional:
  - electric cable 10 m.
  - the distance can be increased by fitting a junction box.

### OPTIES

1. Motor with built-in RTS receiver (Orea RTS).
  - 5 m electric cable - optional 10 m electric cable
  - with RTS wall transmitter - optionally without RTS wall transmitter
2. Motor with automatic readjustment; screen will always completely close (Orea WT).
  - without control buttons; end points to be adjusted via cable, via an adjustment set.
  - connectable in parallel (number determined by type of switch).
  - 3 m electric cable, optional 5 or 10m
  - single-pole surface-mounted switch
3. Motor fitted with automatic post-regulation (SLT motor) - this means the motor changes to a lower gear at approx. 10 cm before the box closes, so that the sunblind stops correctly and there is no need to make a readjustment for any stretching of the fabric.
4. without switch
  - RTS and IO motors are supplied with the options "back release" and "reduced closing force" activated

**Figure 17:** outfeeds (cable bushing)

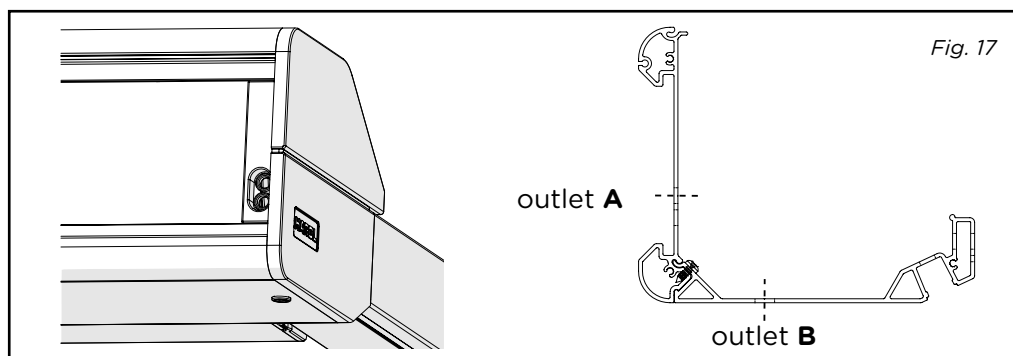

### 5.2. Automation

- Accessories (For this, see the Harol Domotics folder):
  - Relay boxes
  - Wind-and-solar control
  - Time switches
  - Remote control
  - ....



# TECHNICAL DATA SHEET TERRACE AWNING VERSUZ

## 6. TECHNICAL OPTIONS

- Minimum width per element: 1.5 m
- Maximum width per element: 4 m
- Maximum drop: 4 m
- Maximum surface area per fabric: 16 m<sup>2</sup>
- Maximum run-out height (G) 2.9 m

Type			1	4	8	12	16	Maximum surface area	Number of elements	Number of motors
Type 1	1 element		1 part					16 m <sup>2</sup>	1	1
Type 2	2 elements		2 parts					32 m <sup>2</sup>	2	1
Type 3	3 elements		3 parts					48 m <sup>2</sup>	3	2
Type 4	4 elements		4 parts					64 m <sup>2</sup>	4	2

**Table 1:** Technical options

See roll-up tables page 17 for detailed dimensions per fabric type.

**Figure 18:** Measuring and assembling

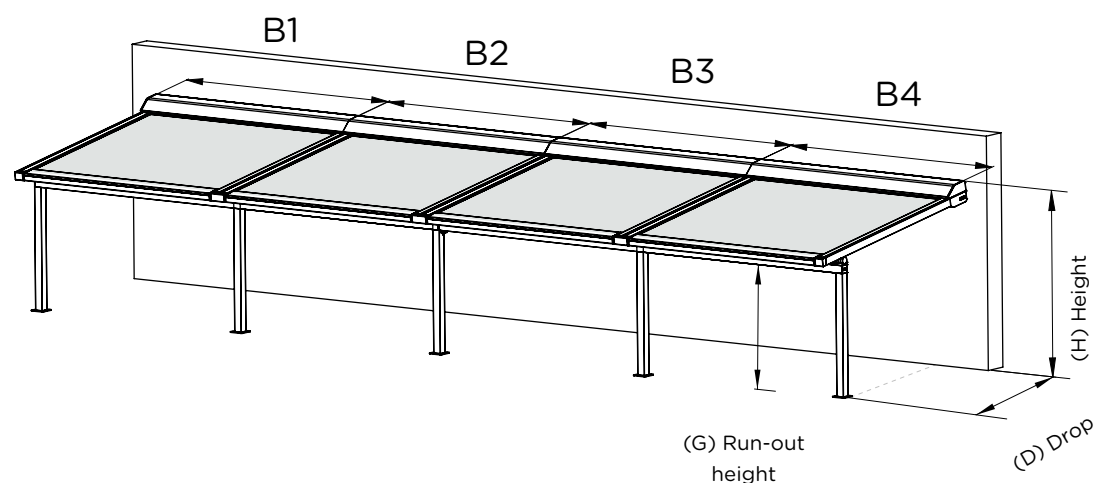

**IN LINKED SYSTEMS THE INTERMEDIATE POSTS ALWAYS HAVE A FIXED POSITION, JUST BELOW THE CENTRAL GUIDE**

## 7. MEASURING AND ASSEMBLING

### 7.1. Guidelines for correct measuring

- Take care that the system is perfectly parallel and squared. An accurate measurement ensures a quicker and easier assembly.
- Take care of an exact level measurement.
- Ensure that the foundation is sufficiently solid for the assembly of the foot mounting supports
- Be careful with relatively weak walls: the standard fixings are not included. Seek advice from your specialist supplier (such as Fischer, Würth, Hilti, ...)

- The total width (W) = outside of left side console up to outside of right side console. The post structure is of the same width as the box.
- The drop (D) : depth, measured horizontally, from the wall to the front of the vertical post.
- The final position of the extension pole can be set flush with the end of the cover of the guide rail.
- Run-out height (G) = height at the front, in between the posts, from the floor (zero level) to the base of the horizontal crossbar.

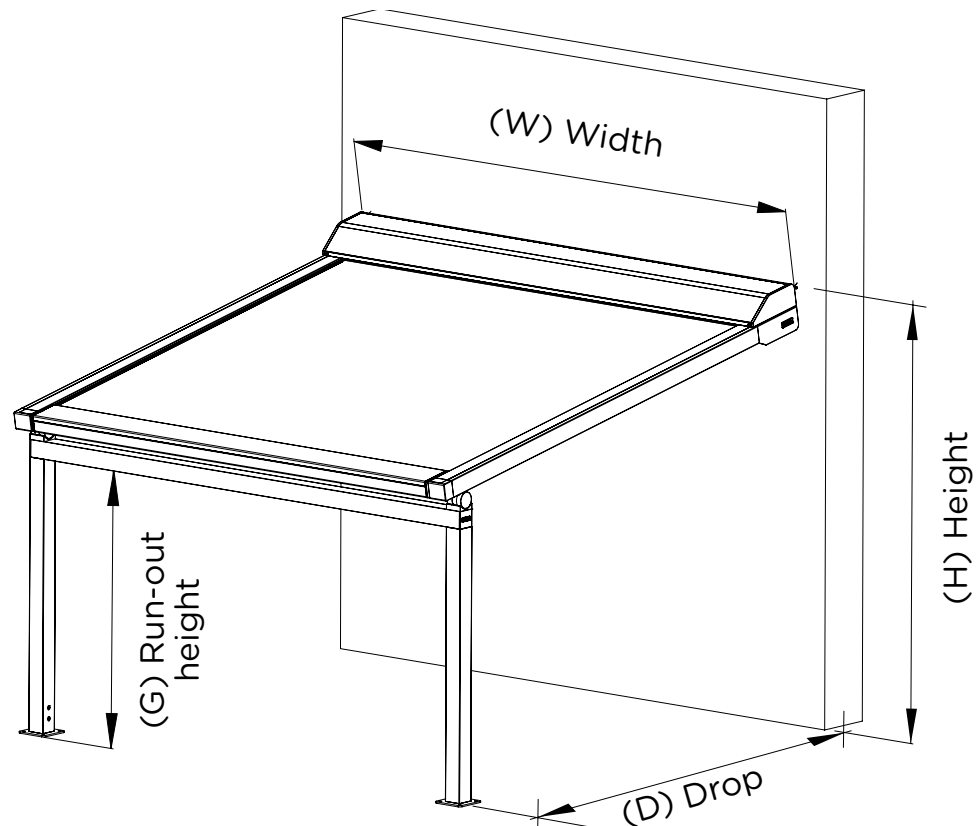

AS STANDARD THE POST STRUCTURE HAS THE SAME WIDTH AS THE SUN PROTECTION

# TECHNICAL DATA SHEET TERRACE AWNING VERSUZ

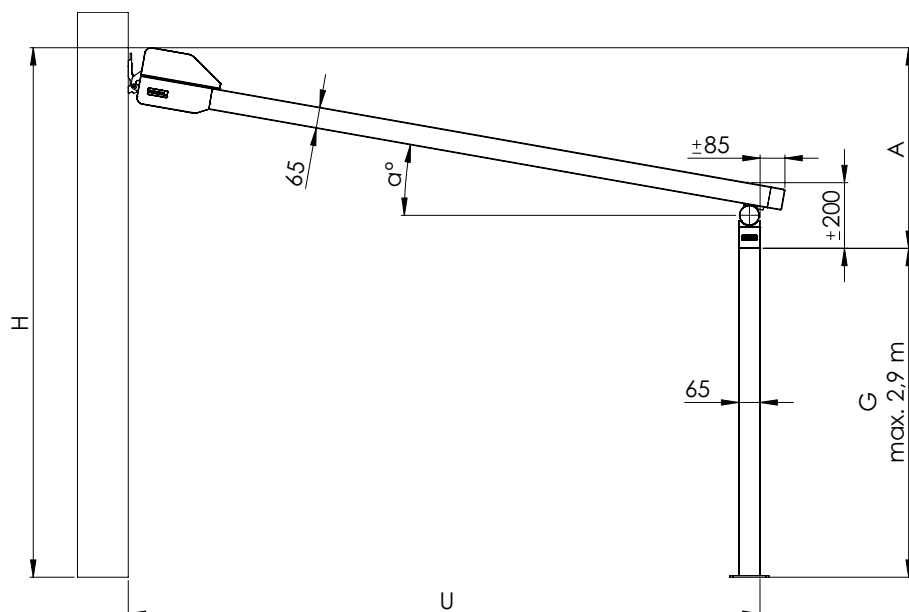

A: Slope (mm) =  $H - G$   
 B: Width  
 G: run-out height (Max. 2,9m)  
 H: Total height incl. box  
 P: Lengthen posts  
 Q: Shorten posts  
 U: Drop  
 U': Total drop with overhang =  $U + Z$   
 X: posts inwards  
 Y: posts outwards  
 Z: overhang

## SLOPE (A) IN MM

drop (U)	Slope angle (a)	8°	10°	14°
	1500	490	535	645
	2000	560	620	770
	2500	630	705	895
	3000	700	970	1020
	3500	770	1055	1145
	4000	840	1145	1270

**\* MINIMUM SLOPE = 8°**

**MAXIMUM SLOPE = 30°**

\* see fabric type p.14 / under LED lighting min. 10°

**WARNING. CHECK THAT THE SLOPE OF THE STRUCTURE IS BIGGER THAN OR EQUAL TO THE VALUE SHOWN IN THE TABLE ABOVE IN ORDER TO ENSURE THE PROPER DRAINAGE OF THE WATER ON THE FRONT.**

*If the slope (A) of the structure is insufficient to ensure the proper water drainage, HAROL ensures the product only as sunscreen; then no claim can be made against the company in the event of malfunctions or defects due to non-drainage of the water.*

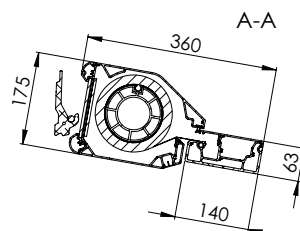
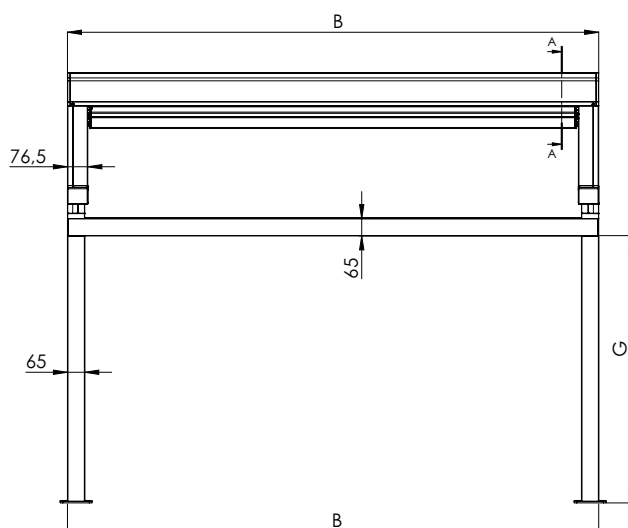

# TECHNICAL DATA SHEET TERRACE AWNING VERSUZ

## OPTIONS

### OPTION 1 A1620 posts inwards

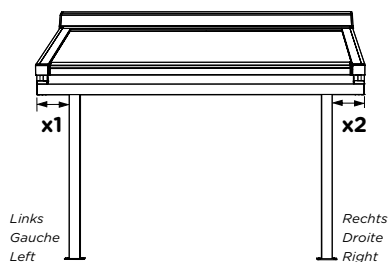
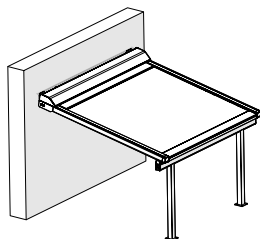

  $x(1)(2)$  : Min. 65 mm  
Max. 500 mm

### OPTION 2 A1621 post outwards

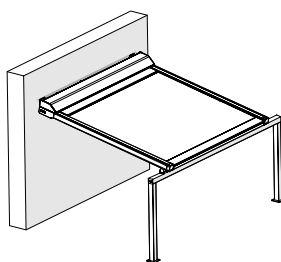

  $y(1)(2)$  : Min. 65 mm  
Max. 500 mm

### OPTION 3 A1622 overhang

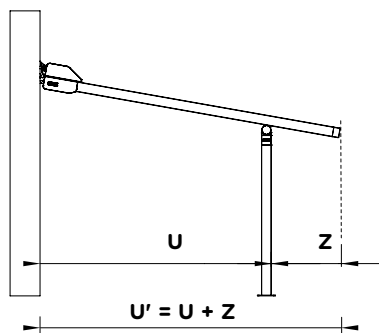
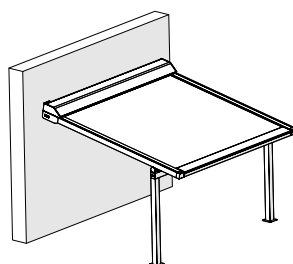

$U' = \text{MAX. } 4\text{m}$

  $Z$  : Min. 85 mm  
Max. 1000 mm

**attention!**  
the extension pole may  
fall lower than the run-out  
height (G)

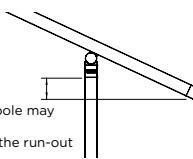

### OPTION 4 A1623 shorten post

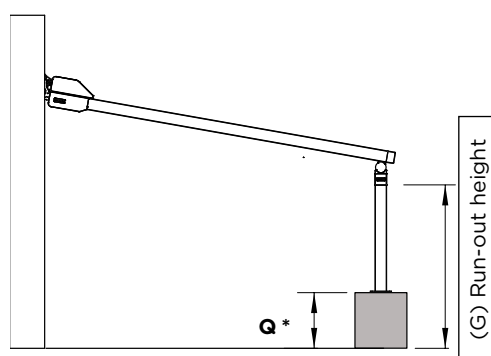

\* indicated dimension is the part that is subtracted.

### OPTION 5 A1624 lengthen post

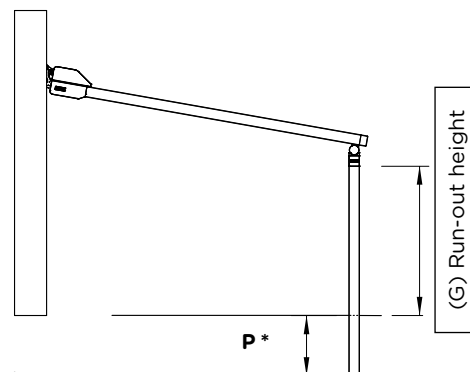

\* indicated dimension is the part that  
is added.



Make sure the box and extension pole can always be opened, to ensure that the mechanical parts inside are accessible at all times. If this rule is not followed, Harol cannot be held responsible for the cost of demolition work!

## 7.2. Assembly

- Please note: always ensure a right-angled fitting. If the assembly is not right-angled, this will greatly increase the risk of wrinkles in the fabric.
- The maximum overhang is 1000 mm.

## 7.3 The wall bracket (standard)

- For mounting against the wall.
- Width: 90 mm and provided with two M12 slotted holes.
- Fitted with a hook at the front for bearing the shaft (wall bracket part 2) see fig. 15 p.7.
- The number of wall brackets supplied always depends on the screen type.
- Two brackets per box part are supplied.
- Provide anchoring based on the ground.

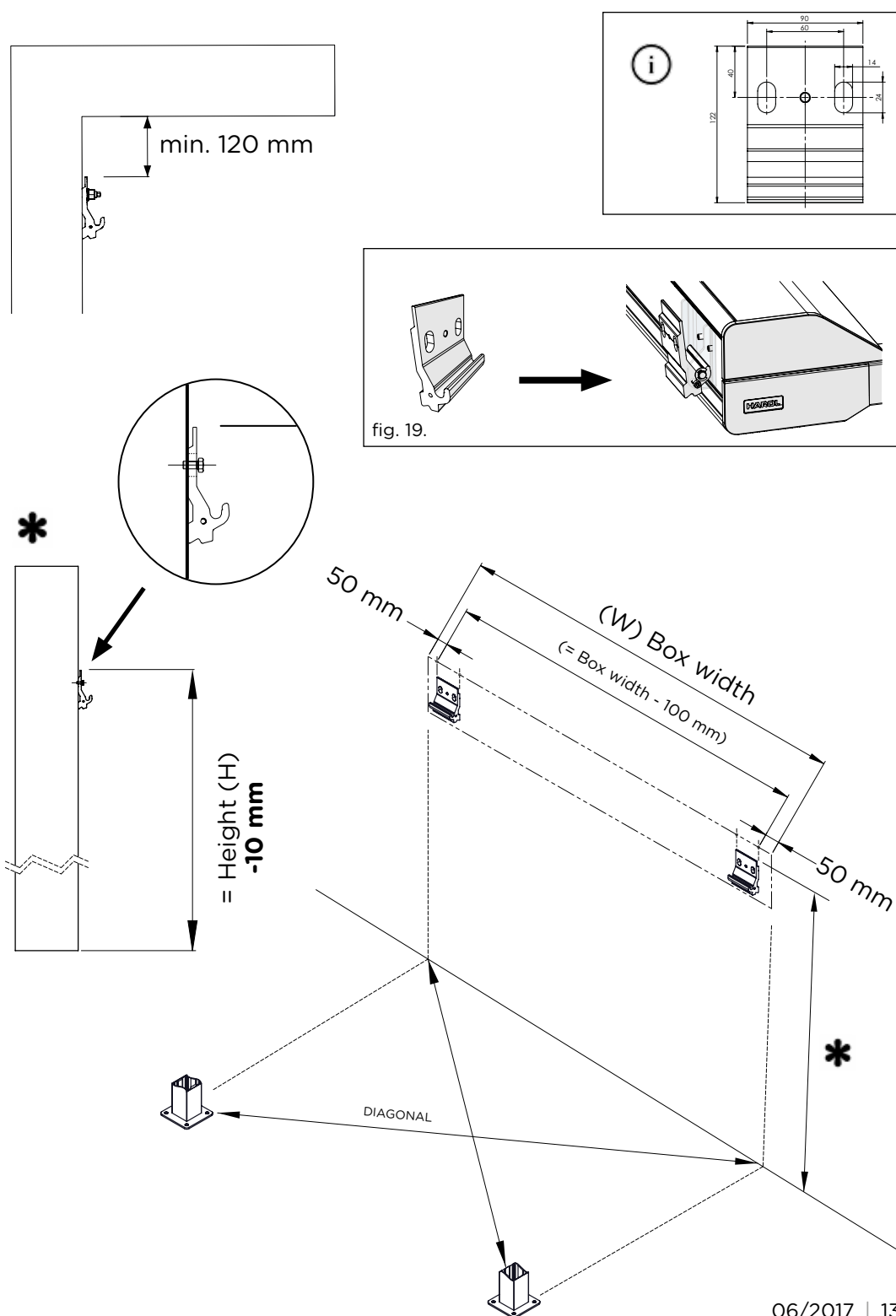

## 8. FABRICS

	SOLTIS 86	SOLTIS 92	SUNWORKER	EXPANSION
basic material	Polyester	Polyester	Polyester	75% Acryl 25% pvc
weight (g/m <sup>2</sup> )	approx. 380	approx. 420	approx. 440	approx. 420
thickness (mm)	approx. 0,43	approx. 0,45	approx. 0,48	approx. 0,60
fire class	M1	M1	M2	-
roll width (mm)	1770 / 2670	1770 / 2670	2960	3000
strip direction	Horizontal	Horizontal	Horizontal	Horizontal
opening factor	14%	3 to 4%	4%	0%
G <sub>tot</sub>	0,12 - 0,22	0,05 - 0,15	0,10 - 0,18	0,08 - 0,14

Choice of different types of fabric:

**Table 2:**

*Technical data of the fabrics*

### 1. Soltis 86 and Soltis 92

- Transparent and refractive fabric.
- Woven from polyester thread, stretched under great tension and secured with a plastisol layer.
- Varnished on two sides -> excellent protection against UV radiation.
- High tear strength without additional reinforcement.
- Durable and dirt repellent.
- Exceptional dimensional stability when used between -30 °C and +70 °C.
- Sunblinds with a drop of -> 2670 mm are fitted with a horizontal weld seam!
- With two-tone fabrics, the Alu side is always on the outside or on the garden side.
- Minimum slope angle 8°, if there is a chance of light rain on the fabric.

### 2. Sunworker Crystal

- Waterproof and translucent
- Fabric of high-tensile polyester thread
- Strong threads that join up various layers and in doing so distribute the mechanical energy.
- Special coating that protects colours from UV radiation in all weather conditions.
- Minimum angle of 14°
- Sun protection with a drop of -> 2960 mm is fitted with a horizontal weld seam!

### 3. Expansion

- The fine, transparent membrane gives the EXPANSION fabric a matt appearance of genuine fabric.
- It is completely waterproof.
- The first acrylic fabric coloured in mass with a smooth surface on the outside to prevent any dirt from penetrating.
- Minimum angle of 14° (light rain)
- Sun protection with a drop of -> 3000 mm is fitted with a horizontal weld seam!

## 4. Finish

Zippers are placed on the sides of each fabric, and with correctly fitted guide rails, the zippers ensure that the fabric is taut in any height position of the extension pole, thanks to the tension between the zipper and the guide rails.

*A crackling sound may be heard when rolling up the blind, caused by the fabric being under tension. (cause: the expulsion of the air between the surfaces of the fabric). Does not affect its functioning so any complaints cannot be accepted*

*Along the side of the fabric, where the zipper is welded, wrinkles will form. This phenomenon is caused by the difference in thickness of the material and their expansion factors.*

With the Soltis 86/92 fabrics, the zippers are always on the underside of the fabric. In addition to the options for applying letters or logos to the fabric, there is also the option to invert the fabric colour or fabric side on the sunblind (A490) - see illustration. Option A490 can not be used for Expansion en Sunwoker fabrics.

**Figure 20:**  
Visualisation option  
A490

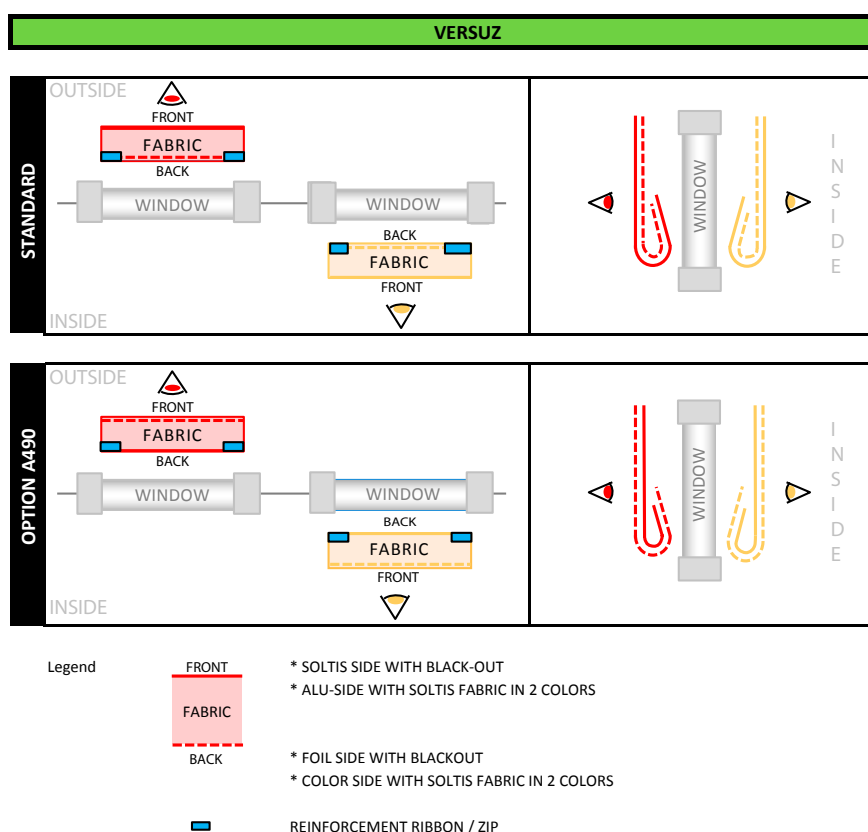

## TECHNICAL DATA SHEET TERRACE AWNING VERSUZ

### 9. WEIGHT

The approximate weight of the box based on a fabric roll of Ø 110, an LT-50 motor and a Soltis fabric, and the weight of two standard lateral guides can be found in the table below.

For a VERSUZ with a width of 1.5 metres, drop 2 metres and a height of 2 metres, the total weight is approx. 90 kg.

**Table 3:**

*Weights of the box, 2 lateral guides, coupling guide and post structure*

BOX		2 LATERAL GUIDES		COUPLING GUIDE RAIL		POSTS STRUCTURE	
LENGTH	WEIGHT	LENGTH	WEIGHT	LENGTH	WEIGHT	LENGTH	WEIGHT
1.0 m	Approx. 25 kg	1.0 m	Approx. 5 kg	1.0 m	Approx. 4 kg	1.0 m	/
1.5 m	Approx. 35 kg	2.0 m	Approx. 10 kg	2.0 m	Approx. 8 kg	2.0 m	Approx. 25 kg
2.0 m	Approx. 45 kg	3.0 m	Approx. 15 kg	3.0 m	Approx. 12 kg	3.0 m	Approx. 37.5 kg
2.5 m	Approx. 55 kg	4.0 m	Approx. 20 kg	4.0 m	Approx. 16 kg		
3.0 m	Approx. 65 kg						
3.5 m	Approx. 75 kg						
4.0 m	Approx. 85 kg						

### 10. FRAME COLOUR

According to RAL colour range.

### 11. FASTENING MATERIALS

All fastening materials are of stainless steel and accessories are always included. Fastening materials for wall and ground are not included.

### 12. PACKAGING

All sunblinds are fully packed in solid cardboard boxes.

### 13. USE AND MAINTENANCE

Proper use and maintenance greatly increase the lifetime of the sunblind.

- Do not use the blind as a rain or wind screen. When using a waterproof fabric, water is drained freely to the sides of the extension pole.
- Regular maintenance prevents unnecessary wear and operational problems.
- Cleaning the frame: use soft water instead of aggressive substances, which may affect the coatings and protective layers.
- Cleaning the fabric: dry with a slightly stiffer brush.
- With stubborn stains: clean with a tepid water and light detergent solution, rinse with copious amounts of clean water.
- Always let the fabric dry fully before rolling it up (even after an unexpected rain shower).
- It is recommended to offer the end customer a maintenance contract for this product.
- Not as 100% rain protection. (rainwater can even penetrate between a wall and the box).



# TECHNICAL DATA SHEET TERRACE AWNING VERSUZ

## 14. SAFETY

For the safety of the end user, the sun protection must be installed strictly in accordance with the installation instructions.

## 15. ROLL-UP TABLES

Below you will find the possible dimensions for a VERSUZ Type 1 (single screen). For VERSUZ Type 2, Type 3 or Type 4 there are two or more fabrics, each of which can be found in the table below.

		1500	1750	2000	2250	2500	2750	3000	4000
SOLTIS 86, 92	height								
	500								
	750								
	1000								
	1250								
	1500								
	1750								
	2000								
	2250								
	2500								
	2750								
	3000								
	3250								
	3500								
	3750								
	4000								

		1500	1750	2000	2250	2500	2750	3000	4000
EXPANSION / SUNWORKER CRYSTAL	height								
	500								
	750								
	1000								
	1250								
	1500								
	1750								
	2000								
	2250								
	2500								
	2750								
	3000								
	3250								
	3500								
	3750								
	4000								

# TECHNICAL DATA SHEET TERRACE AWNING VERSUZ

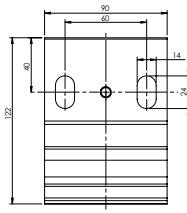
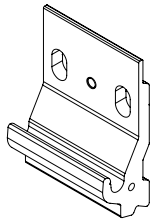

STANDARD

TYPE 2

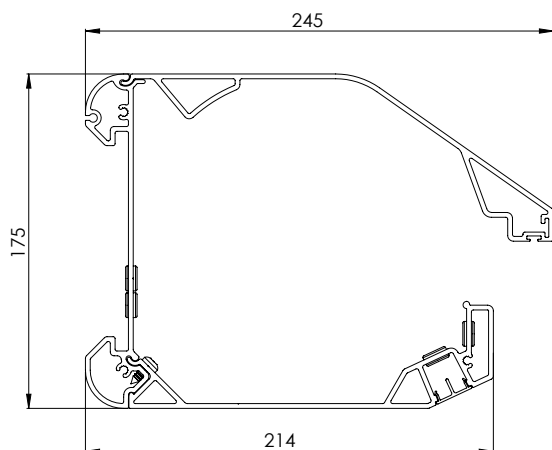
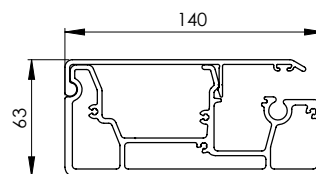
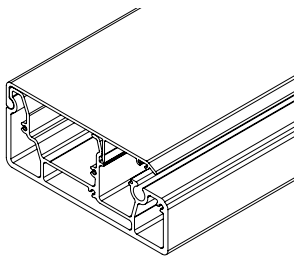
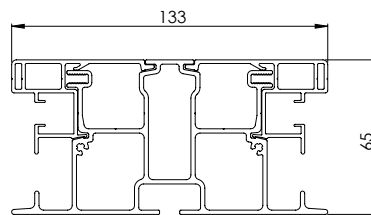
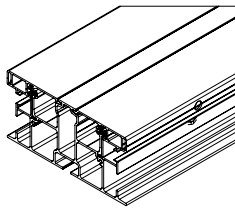
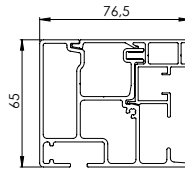
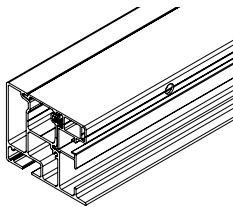
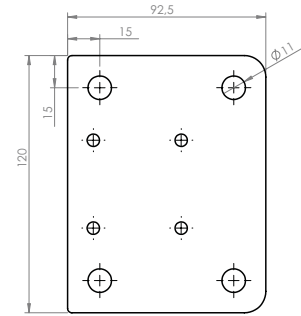
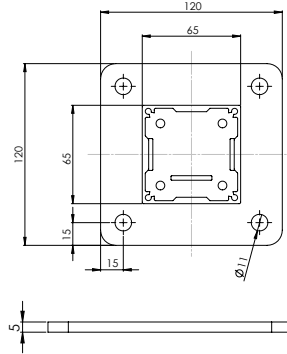
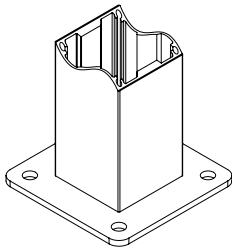

# Order form terrace awning **VERSUZ**

## 1. Type:

see Table 1 page 9

Type 1	1 field
Type 2	2 fields
Type 3	3 fields
Type 4	4 fields

## 2. Operating side:

L	Left	Type 1 + 2
R	Right	Type 1 + 2
LS	Left + 2 right parts together	Type 3
SR	2 left parts together + right	Type 3
LR	Left + Right	Type 2 + 4

## 3. Outlet:

A	along the rear side
B	along the base

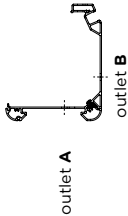

## 4. Dimensions:

see page 10

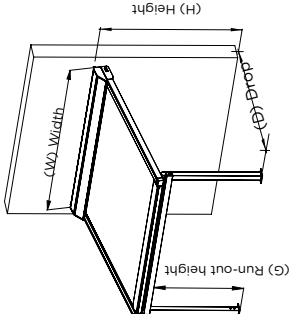

## 5. Optional: A 1620: posts inwards

See option 1 p.11

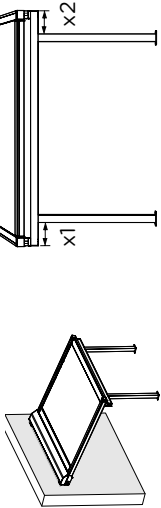

## 6. Optional: A 1621: posts outwards

See option 2 p.11

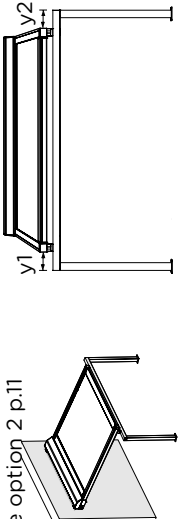

## 7. Optional: A 1622: overhang

See option 3 p.11

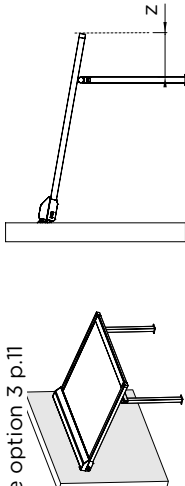

## 8. Optional: A 1623: shorten posts

See option 4 p.11

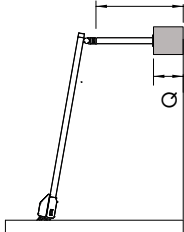

## 9. Optional: A 1624: lengthen posts

See option 5 p.11

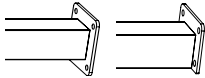
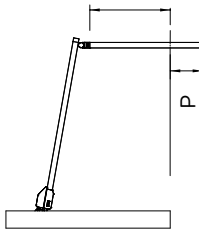

Standard footplate

optional  
footplate **TYPE 2**

## 10. Frame colour:

Choice from the RAL colour range  
RAL colour (indicate no.)

## 11. Fabric:

S86 Soltis 86  
S92 Soltis 92  
SWC Sunworker Crystal  
EXP Expansion

Fabric colour numbers must be specified as found in the collection book.

## 12. Supplements

A 269 Coupling set duo 2 lateral guides  
A 288 Motor cable extensible to 5 m  
A 289 Motor cable extensible to 10 m  
A 1076 Motor Orea RTS  
A 2619 Motor Orea WT  
A 2392 Motor SLT  
A 1117 Without Smoove Origin RTS transmitter  
A 1285 Without Smoove Origin IO transmitter  
A576 PLR retouch pen for RAL colour  
A 2372 Hirschmann plug (switch side)

## 13. LED type

1 standard (A2659)  
2 RTS (A2660)  
3 IO (A2661)  
4 IO dimmable (A2662)

## 14. LED side

1 left  
2 right

Date: \_\_\_\_\_ Formulated by: \_\_\_\_\_ Reference HAROL: \_\_\_\_\_

## CUSTOMER/INVOICE

Name: \_\_\_\_\_  
 Address: \_\_\_\_\_  
 Customer number: \_\_\_\_\_ VAT no: \_\_\_\_\_  
 Mobile/Tel.: \_\_\_\_\_ Fax: \_\_\_\_\_

## DELIVERY ADDRESS

Name: \_\_\_\_\_  
 Address: \_\_\_\_\_  
 Mobile/Tel.: \_\_\_\_\_ Fax: \_\_\_\_\_  
 Desired delivery date: \_\_\_\_\_

QUANTITY	TYPE NO. (1)	OPERATING SIDE (2)	CABLE EXIT (3)	FINISHED MEASUREMENTS (MM) (4)					OPTION A1620 (POSTS NO. INWARDS) (5)			OPTION A1621 (POSTS NO. OUTWARDS) (6)			OPTION A1622 (OVERHANG) (7)
				B	B1	B2	B3	B4	U	G	H	(dimension) X1 /mm	(dimension) Y1 /mm	(dimension) Y2 /mm	(dimension) Z /mm

OPTION A1623 (SHORTEN POSTS) (8)		OPTION A1624 (LENGTHEN POSTS) (9)	FRAME COLOUR (10)	FABRIC (11)		SUPPLEMENTS (12)			LED	
(dimension) Q /mm	(dimension) P /mm			QUALITY	COLOUR				TYPE (13)	SIDE (14)

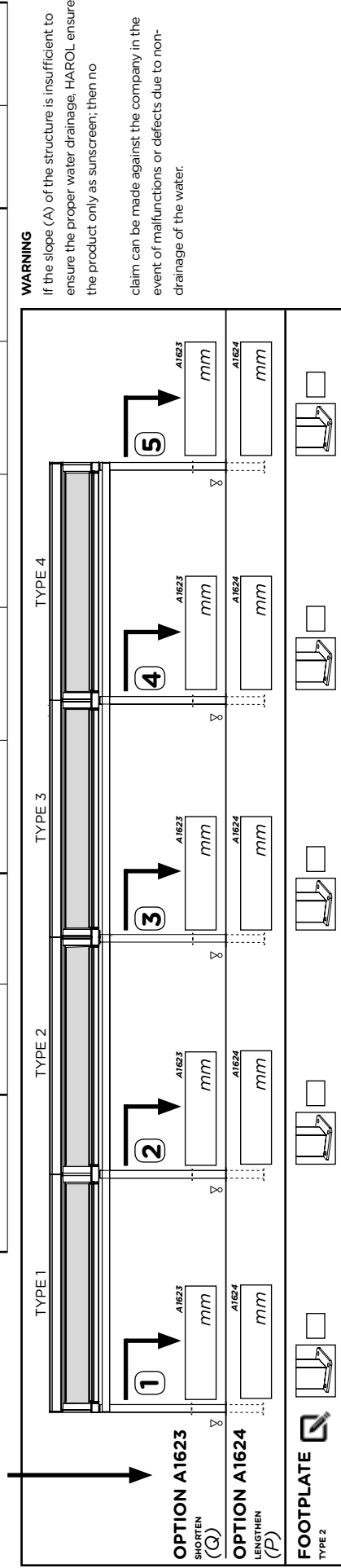

I have taken note of the technical product descriptions and take full responsibility for the indications and sizes mentioned.  
**STAMP AND SIGN FOR ACCOUNTABILITY**  
 The Customer,

### COMMENTS:

### INFORMATION:

- The operating side is always viewed from the outside.
- Please indicate all the measures in mm!
- Each order is executed according to our terms and conditions of sale!

PRICE: \_\_\_\_\_