

SHan

Installation Manual

INDEX

1 - INTRODUCTION	pag. 2
1.1 - Symbols used in the manual.....	pag. 2
1.2 - Personnel qualifications	pag. 2
1.3 - Necessary equipment	pag. 3
1.4 - Before starting installation	pag. 3
2 - SAFETY	pag. 4
2.1 - General safety information	pag. 4
2.2 - Working environment.....	pag. 5
3 - SHAN COMPONENTS AND DIAGRAMS	pag. 6
3.1 - Tilting diagrams	pag. 6
4 - SHAN TECHNICAL SHEET	pag. 7
4.1 - Tilting diagrams	pag. 7
5 - INSTALLATION SHAN	pag. 9
6 - INSTALLATION SHAN - COUPLED VERSION - INTEGRATION	pag. 18



1 – INTRODUCTION

This “assembly manual” for **SHAN** awnings has been produced by **SHADELAB** to supply the indications necessary for the operations of assembling the components that make up the product.

Assembly must be carried out by personnel with suitable technical and professional qualifications, in accordance with the respective national laws or regulations (see Par. 1.2 “Personnel requirements”).

It is forbidden to eliminate, rewrite or alter the pages in the manual and their content.

This manual must be kept intact in all its parts, in an easily accessible place.

SHADELAB reserves the right to update the production and the respective manuals, without being obliged to update the previous production and manuals.

SHADELAB reserves all rights to this manual: no total or partial reproduction is allowed without authorisation in writing.

1.1 - Symbols used in the manual

Shown below are the WARNING symbols used in this manual:



IMPORTANT

Indications and advice to be observed to ensure a correct use of the awning. Failure to follow these indications may endanger the integrity and/or resistance of the product.



ATTENTION

DANGER FOR THE OPERATOR! Instructions and indications to be assessed and followed with care. Failure to follow these indications may endanger personal safety.

1.2 - Personnel requirements

The personnel appointed to perform this operation must possess a technical knowledge of the product, acquired by assembling similar products for at least one year or after having followed a suitable technical training course.



1.2 - Assembly and installation equipment

To ensure the correct assembly of the mechanical part, of the textile part, and consequently the optimum operation of the finished product, it is necessary to be in possession of the following equipment:

- » complete set of tools;
- » equipment for working at heights (trestles, ladders, scaffolding, overhead platforms, etc.) complying with current occupational safety regulations;
- » rawlplugs;
- » spirit level;
- » string.

1.3 - Before starting



IMPORTANT

Some components must be cut to suit the dimensions of the awning that is to be obtained (see Par. 3.3 "Table of cutting dimensions").



2 – SAFETY

2.1 - General safety information

Follow these safety precautions:



ATTENTION

Wear the garments and personal protection equipment contemplated by the safety regulations in force for the workplace (protective helmet, gloves, etc.).



ATTENTION

It is forbidden to use the awning to support yourself: risk of serious personal injury and of damage to the awning itself.



IMPORTANT

Do not lay objects on the awning.



IMPORTANT

This manual is an integral part of the product. Before assembly, carefully read all the instructions given in this manual.



IMPORTANT

SHADELAB guarantees the EC marking only for products supplied by the company itself. If any parts have to be replaced with other components not guaranteed by SHADELAB, the product guarantee will automatically become void and SHADELAB shall not answer for any malfunctions of the product.



ATTENTION

Some awning components are constantly subject to strong pressure (arms) and, if the instructions in this manual are not carefully followed, these components may cause serious harm to persons, animals and things.



ATTENTION

Make sure that the temporary equipment used (trestles, scaffolding, ladders, etc.) and all the personal protective equipment (harnesses, safety belts, etc.) are regulatory and in good condition before using them.



ATTENTION

If the awning must be mounted on a floor higher than the ground floor, cordon off the area and make sure no-one remains under the awning when lifting it.

**ATTENTION**

All handling and lifting operations must be carried out with the greatest of care, making sure that all personnel not involved keep at a safe distance; no-one must remain under suspended loads, whether still or moving.

**ATTENTION**

As regards personal safety, installation must be performed in observance of Decree of the President of the Republic 164/56 and Legislative Decree 494/96.

**IMPORTANT**

During the operations described in this manual, make sure that ONLY qualified personnel enter the work area (see Para. 1.2 "Personnel requirements").

**ATTENTION**

If the awning is installed on a floor higher than the ground floor, the person cleaning the awning must pay greater attention to the risk of falling.

**ATTENTION**

If a ladder is required during installation, make sure that it is firmly placed on the ground in order to prevent it from tipping and causing serious injury to the people involved in installation operations.

**ATTENTION**

Make sure there are no people, animals and objects nearby when the awning opens and closes.



3 - SHAN COMPONENTS AND DIAGRAMS

3.1 Tilting diagrams

Dimensions of closed awning

Wall mounting

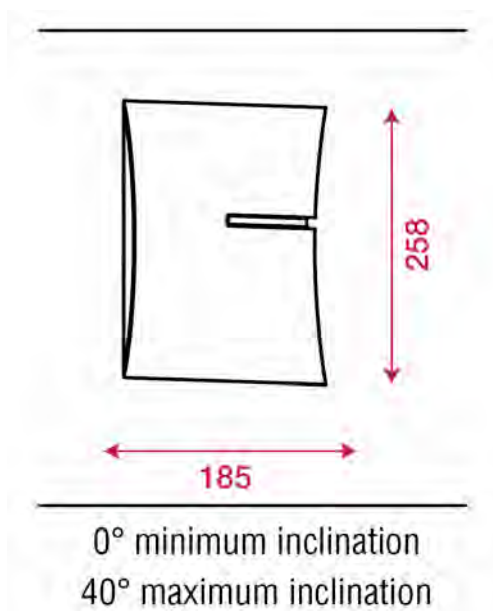

Arm length and inclination

Wall and roof mounting with special bracket

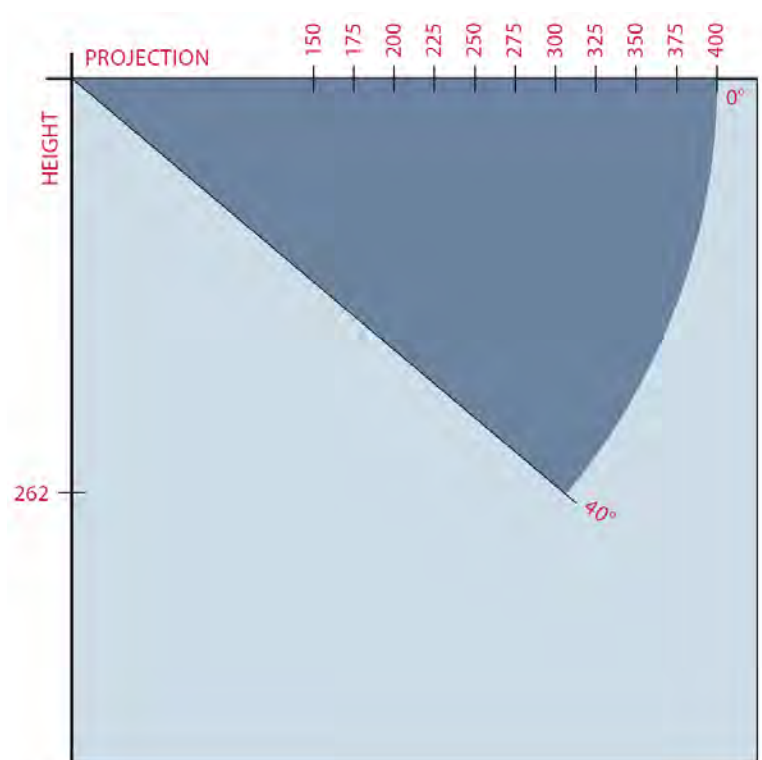



4 - SHAN Technical sheet

Fixing bracket

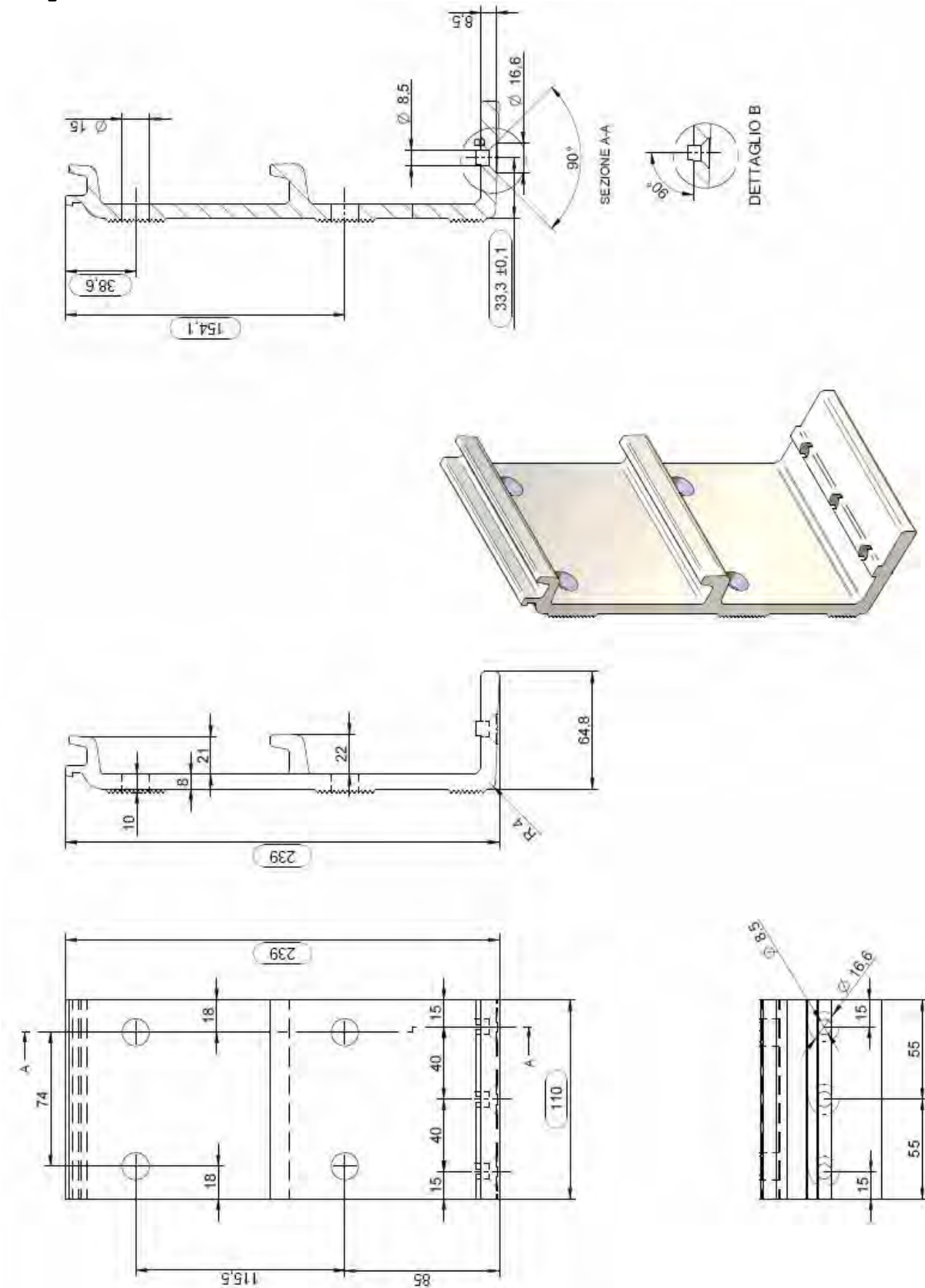



Shan with 2, 3, 4 arms

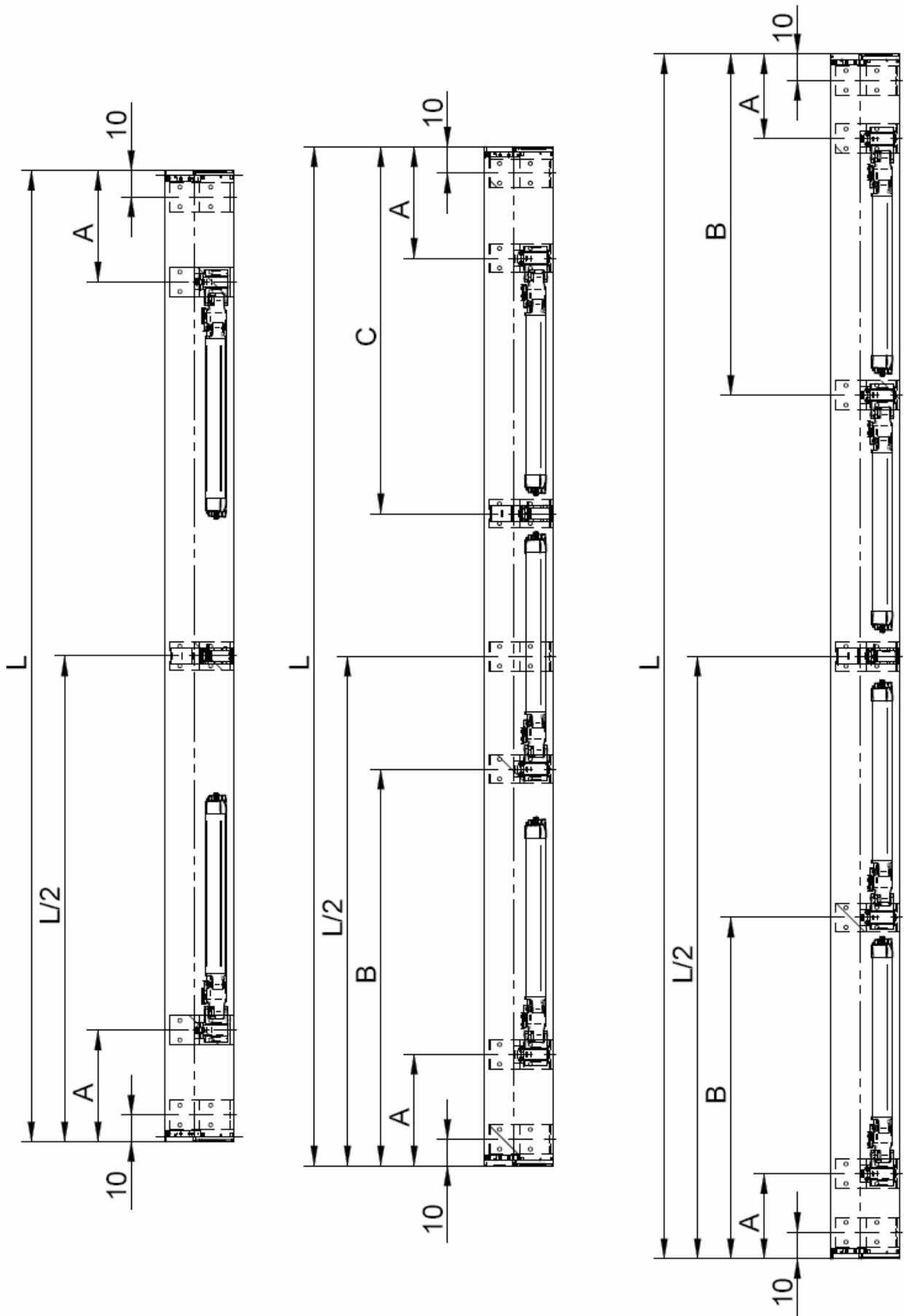



5 – Intallation Shan

Brackets position for Shan on the wall

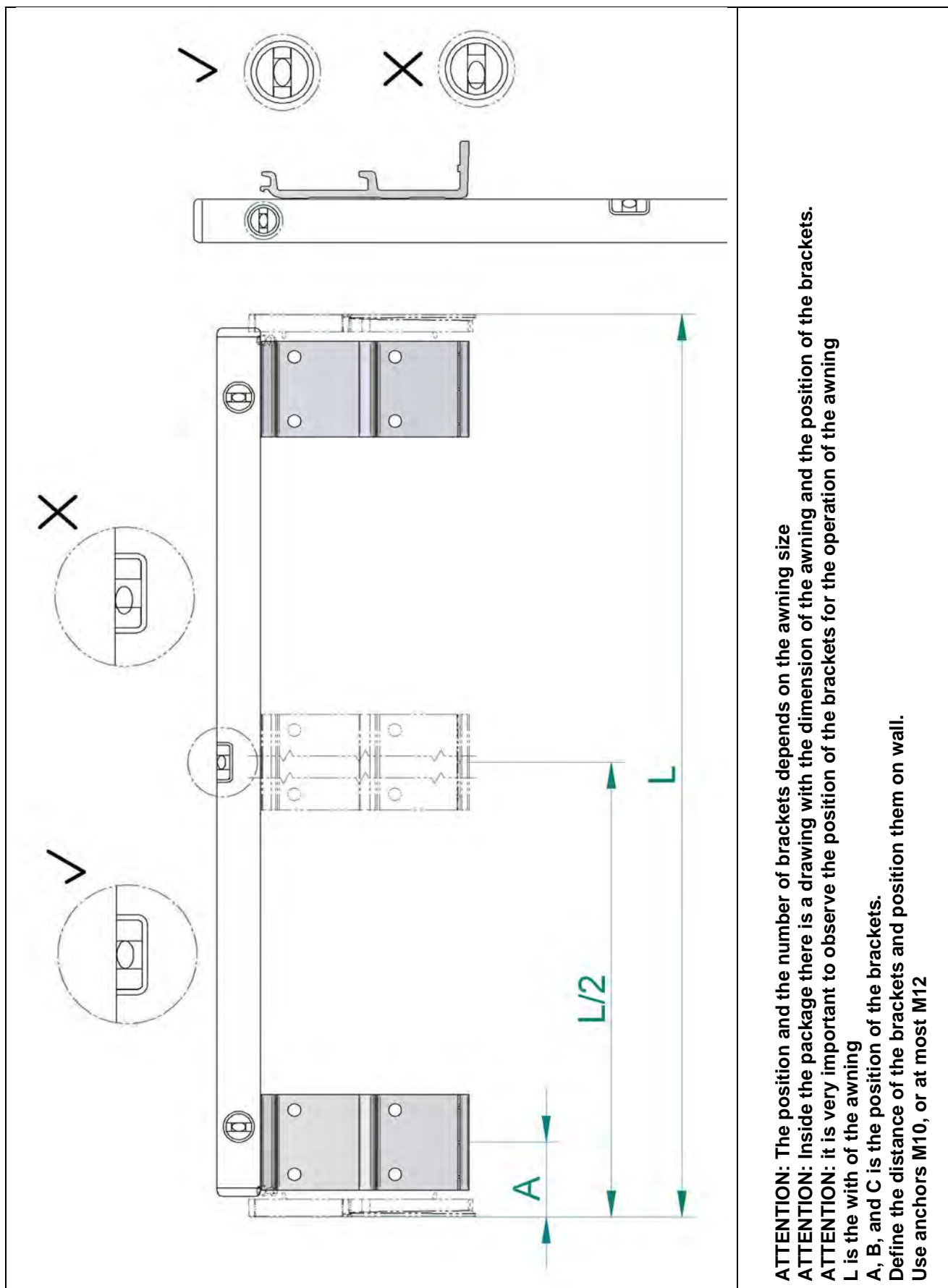



Brackets position for Shan on the wall

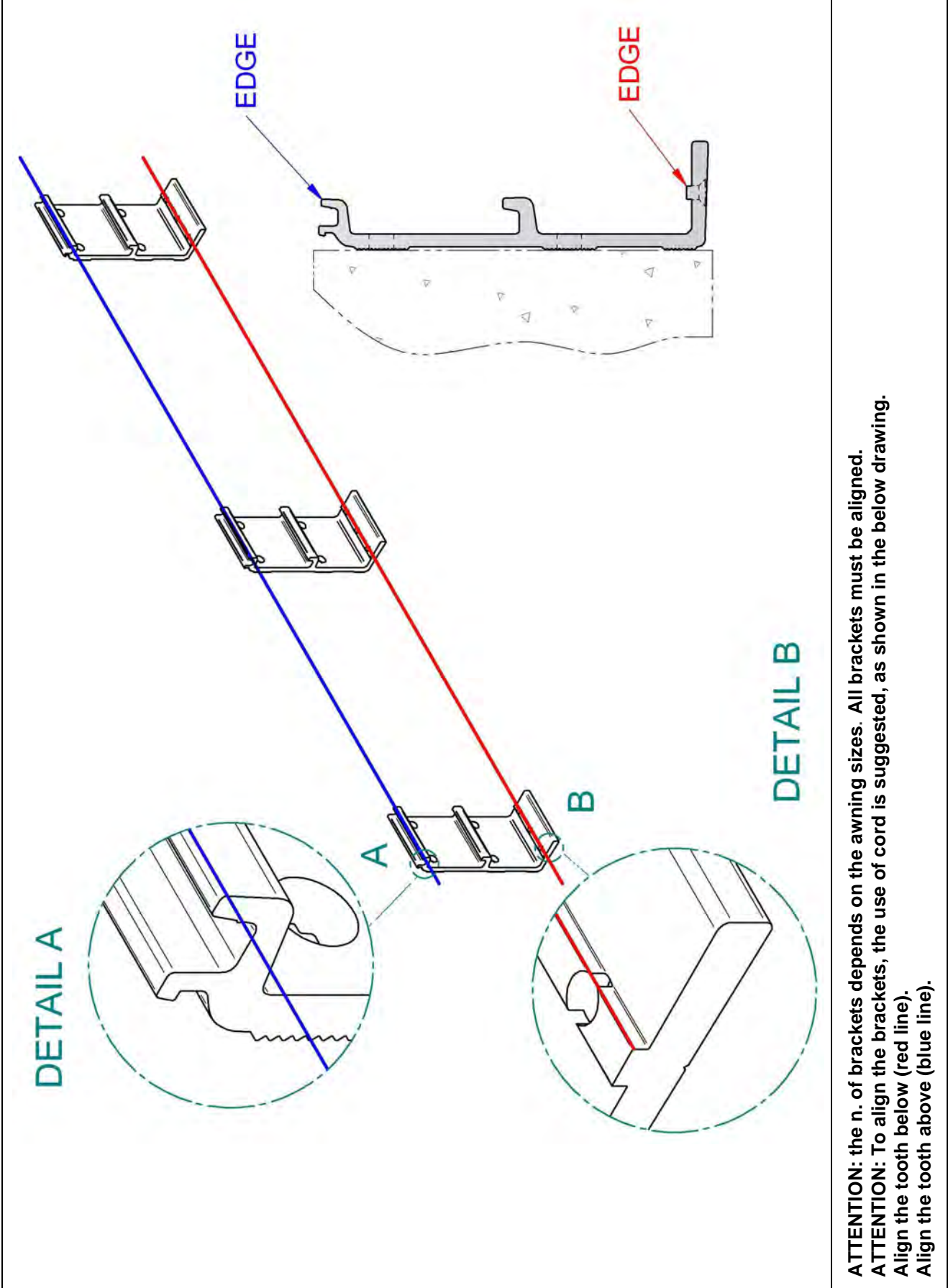



Install Shan

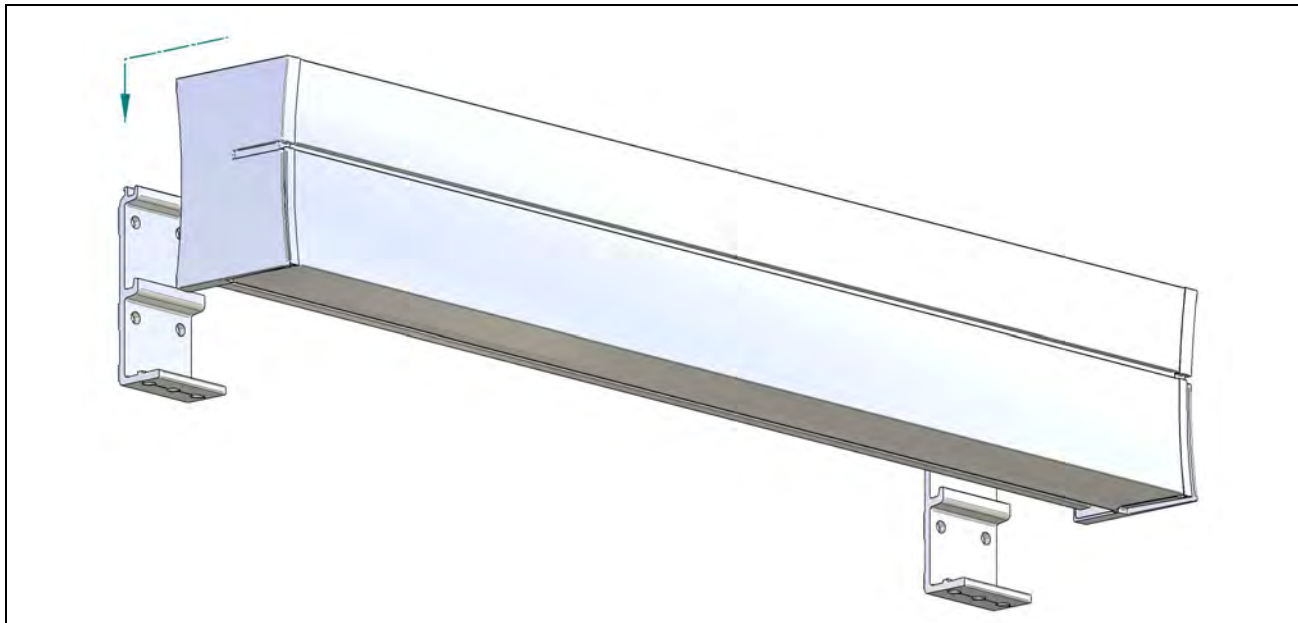

ATTENTION: to respect the position of the awning according to the drawing. The support arm must be in correspondence of the bracket.
ATTENTION: Install the awning on the brackets fixed to the wall

Particular view of the bracket



ATTENTION: Use anchors M10, or at most M12



Fix the awning

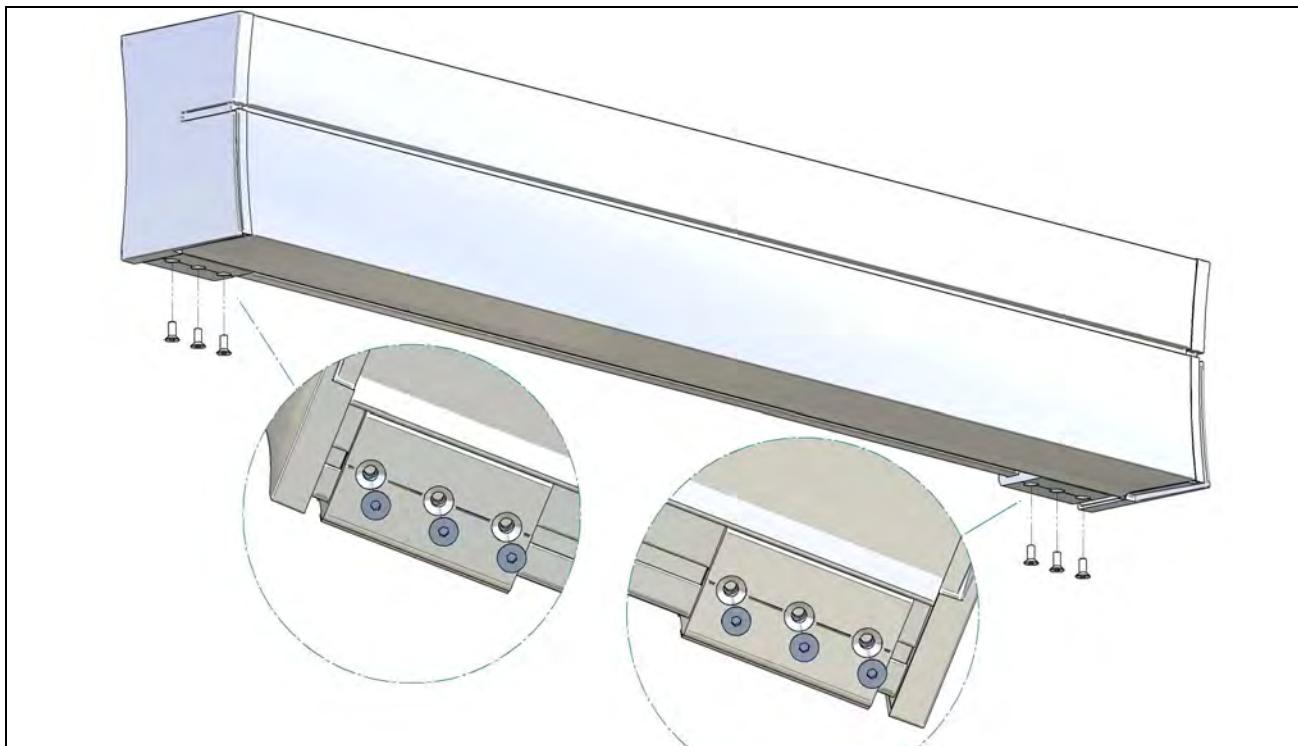

ATTENTION: Block the awning with the screws

Adjusting the awning

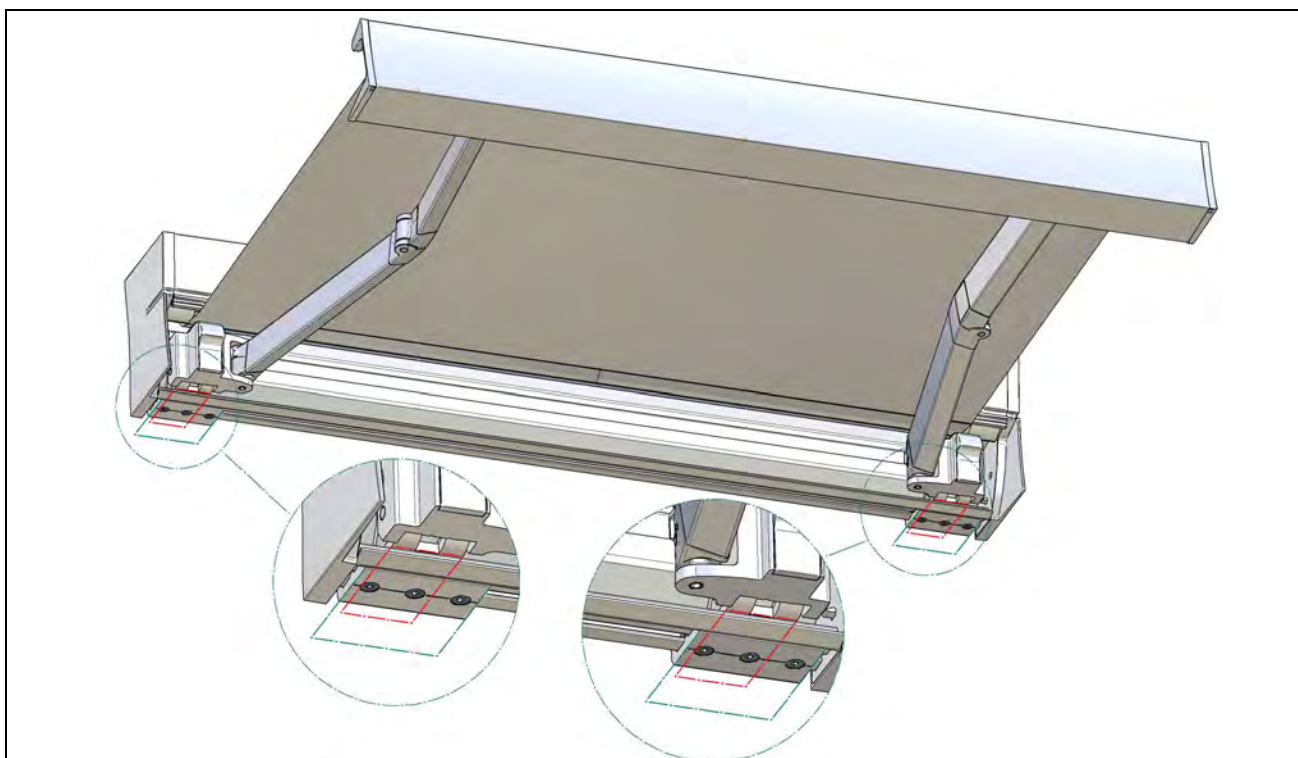

ATTENTION: Ensure that there are no persons, animals or things in the vicinity while opening/closing the awning. Open the awning and check that the brackets are at the arm supports.
ATTENTION: The central part of the support should be within the width of the bracket



Adjusting the awning 1

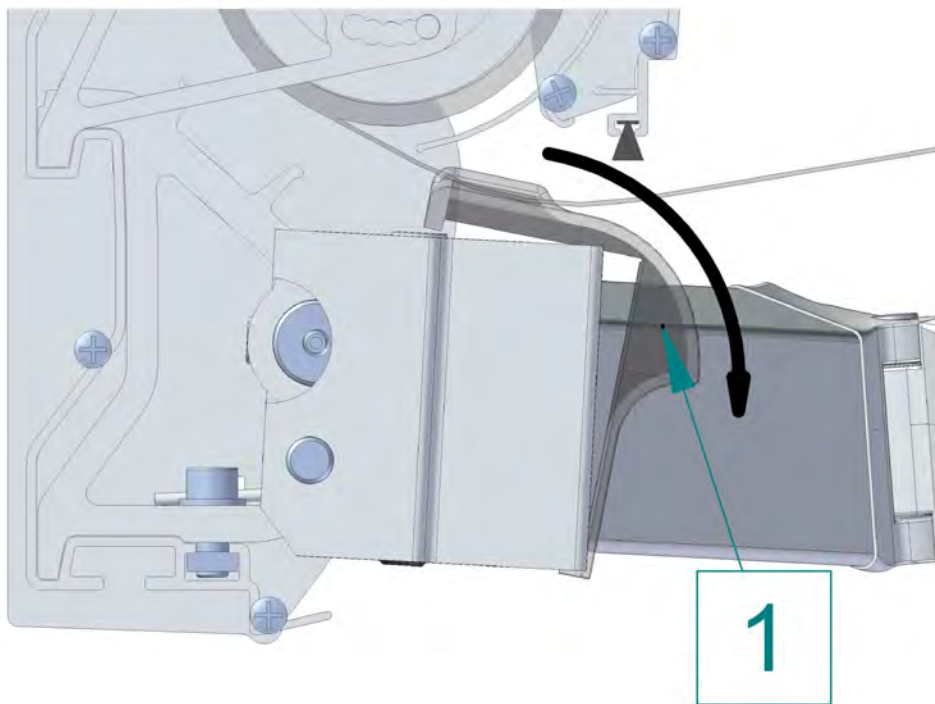

ATTENTION: Remove the conveyor

Adjusting the awning 2

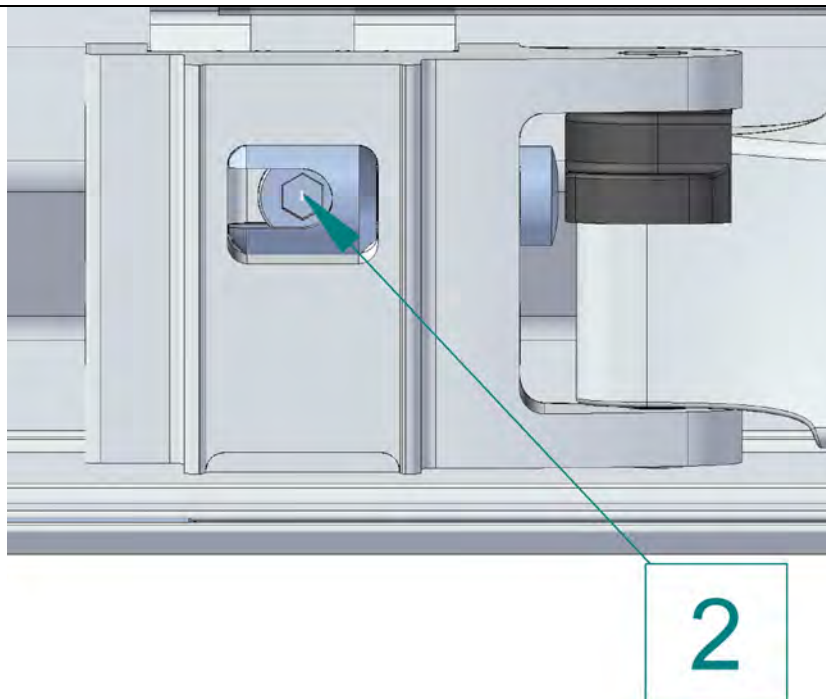

ATTENTION: Loosen the adjustment screw (see ref. 2) to increase the inclination; tighten it to decrease the inclination.

ATTENTION: During adjustment, support the arm or terminal bar to simplify work.

ATTENTION: This operation must be performed by inclining each arm a little at a time

Adjusting the awning 3

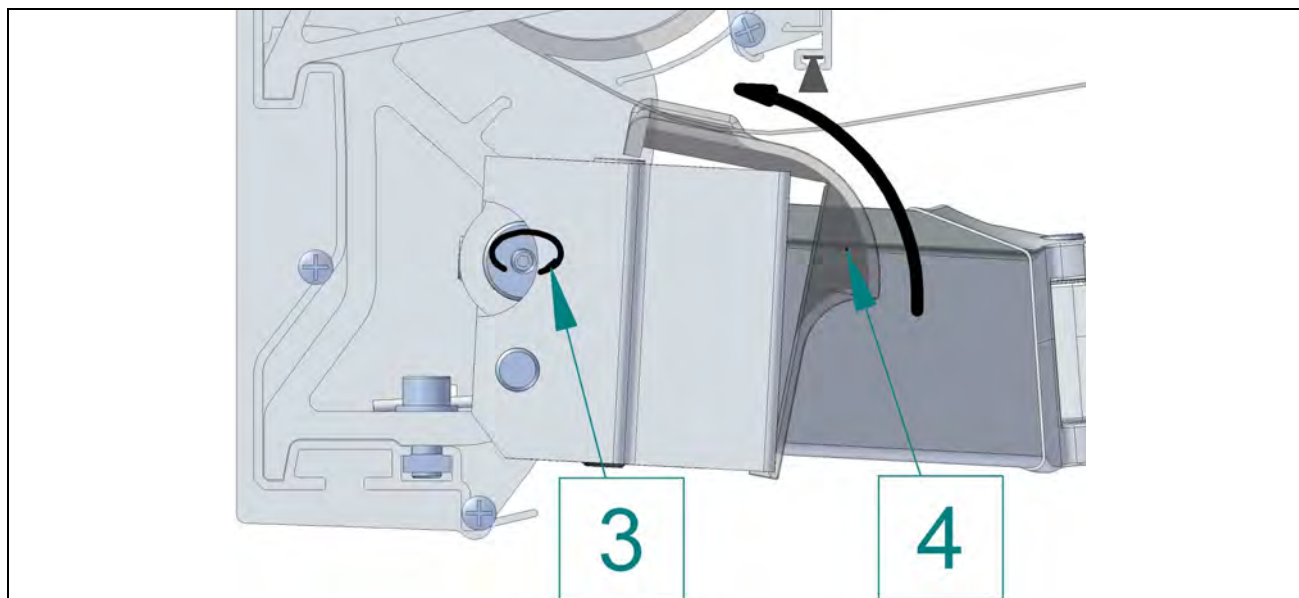

ATTENTION: After reaching the required inclination, tighten the dowel (see ref. 3) on the lateral cylinder and remount the conveyor (see ref. 4).

Regulating the awning

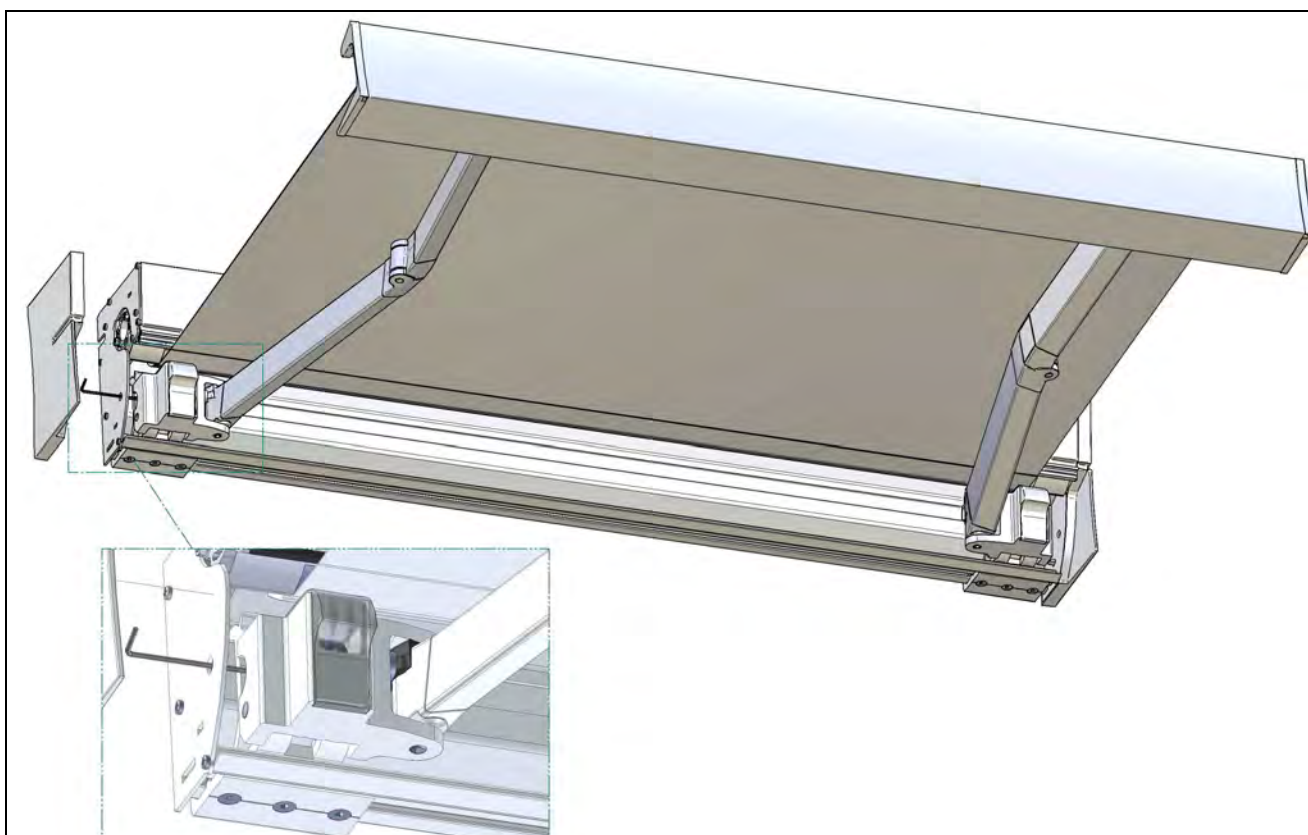

ATTENTION: When the arm support is very close to the side caps, remove the cap acting on the elected and block the dowel (ref 3 of fig. above) as shown in the picture



Regulating the awning

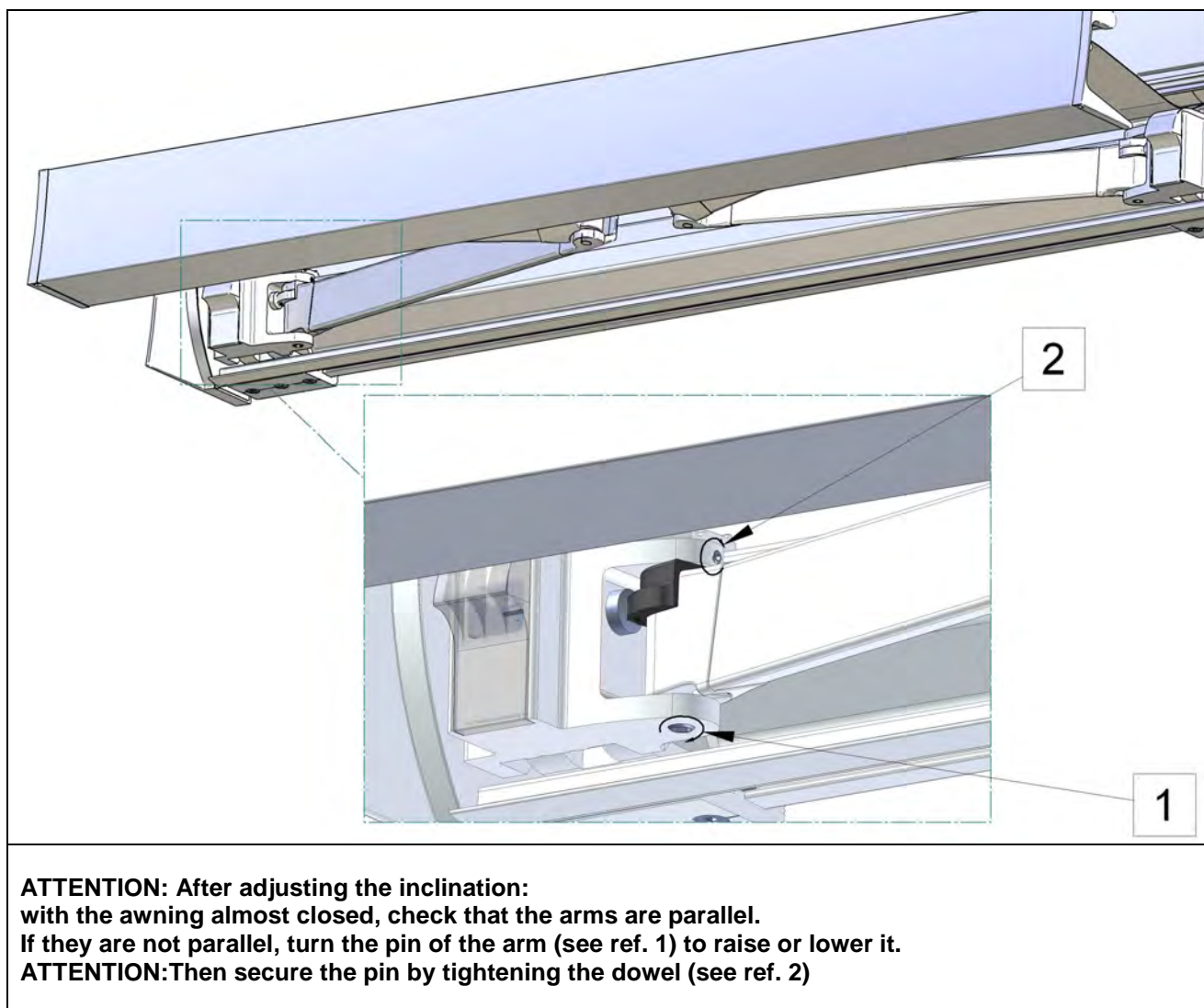

SHAN

Installation manual **COUPLED VERSION - INTEGRATION**



The awning is supplied as shown in figure:

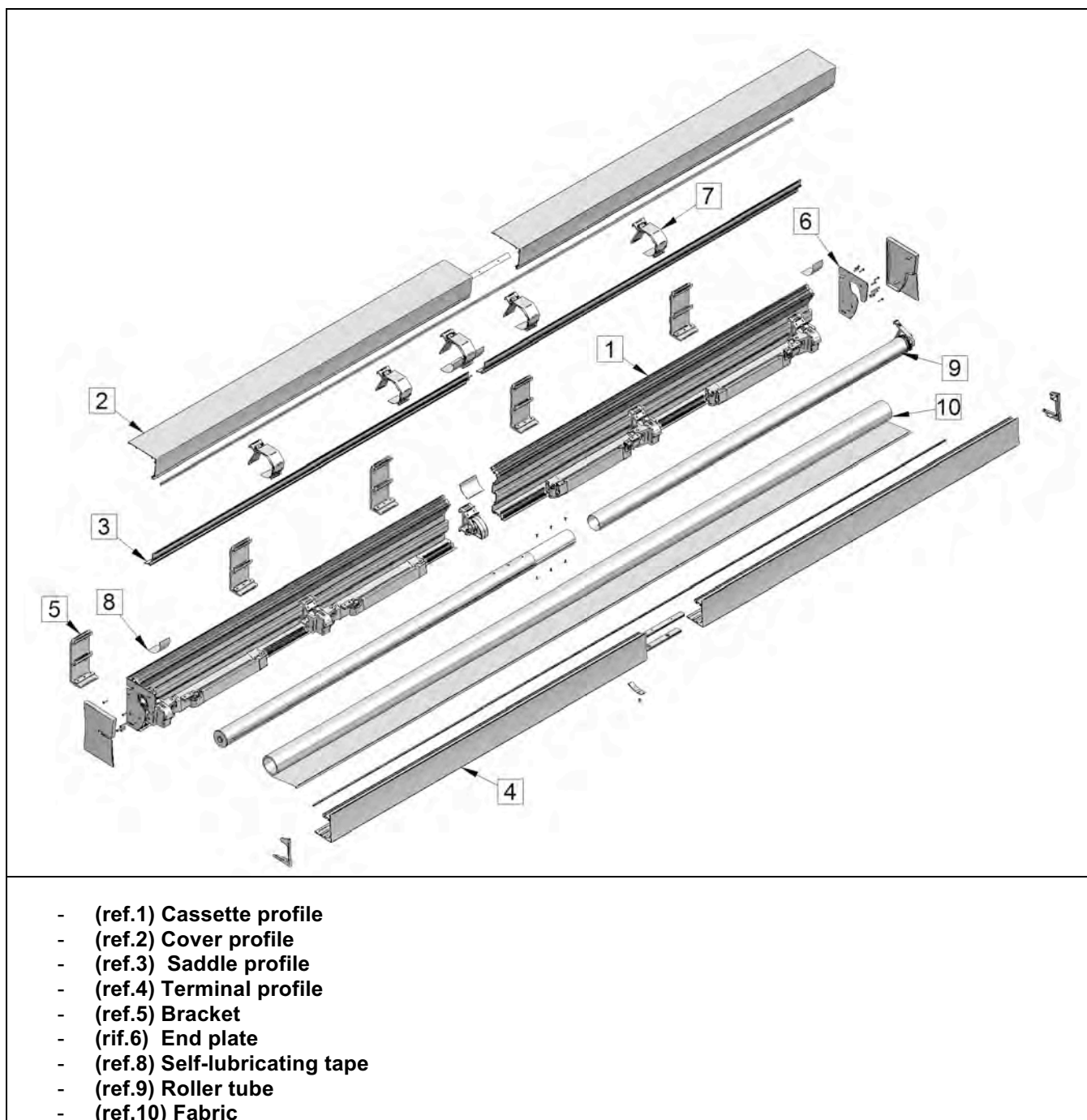



FITTING BACK CASSETTE PROFILES

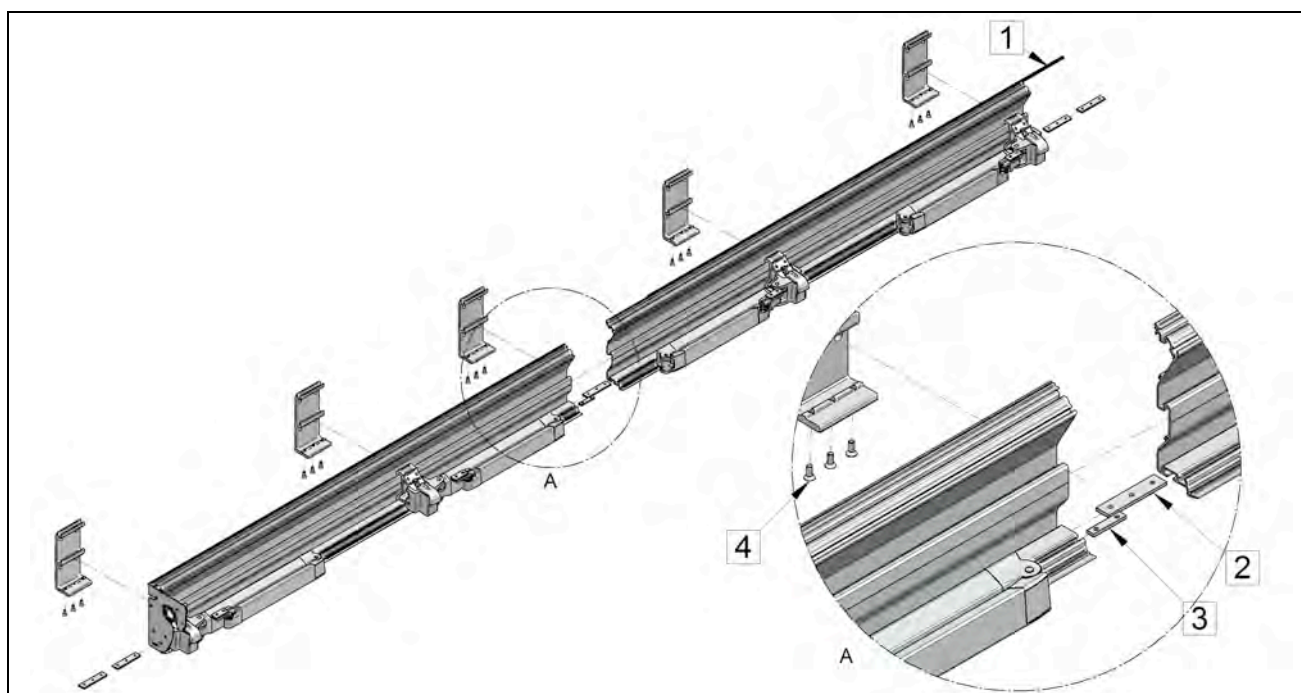

WARNING: Install the brackets; ensure that the gasket (ref. 1) into the back profile is in place; insert the brackets plates (ref. 2) and the central support plate (ref.3) into the cassette.
Fit the cassettes onto the brackets and secure with the M8 countersunk screws (ref. 4) (allen wrench 5).

FITTING CENTRAL SUPPORT

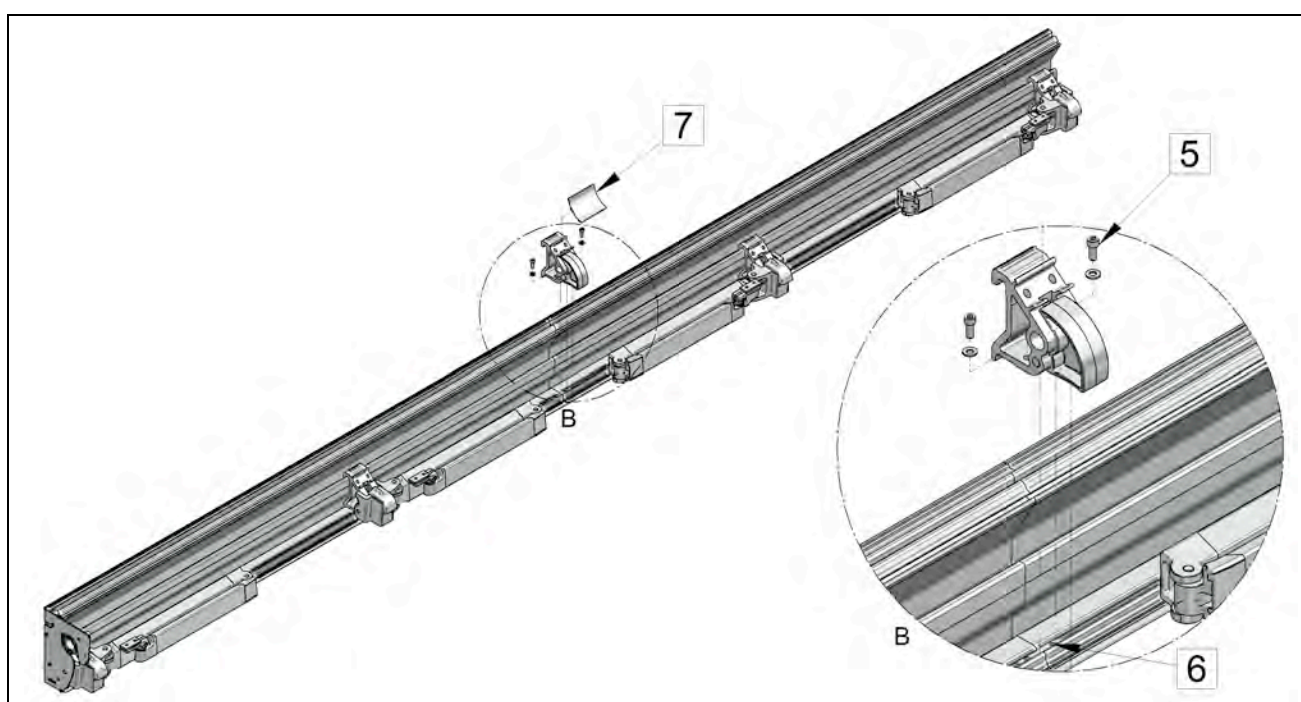

WARNING: Mount the central support and fix it with the M8x20 screws (ref.5) (allen wrench 6) on the plate positioned previously (ref.6); insert the L100 saddle profile (ref.7) on the support.



COUPLING ROLLER TUBE/FABRIC

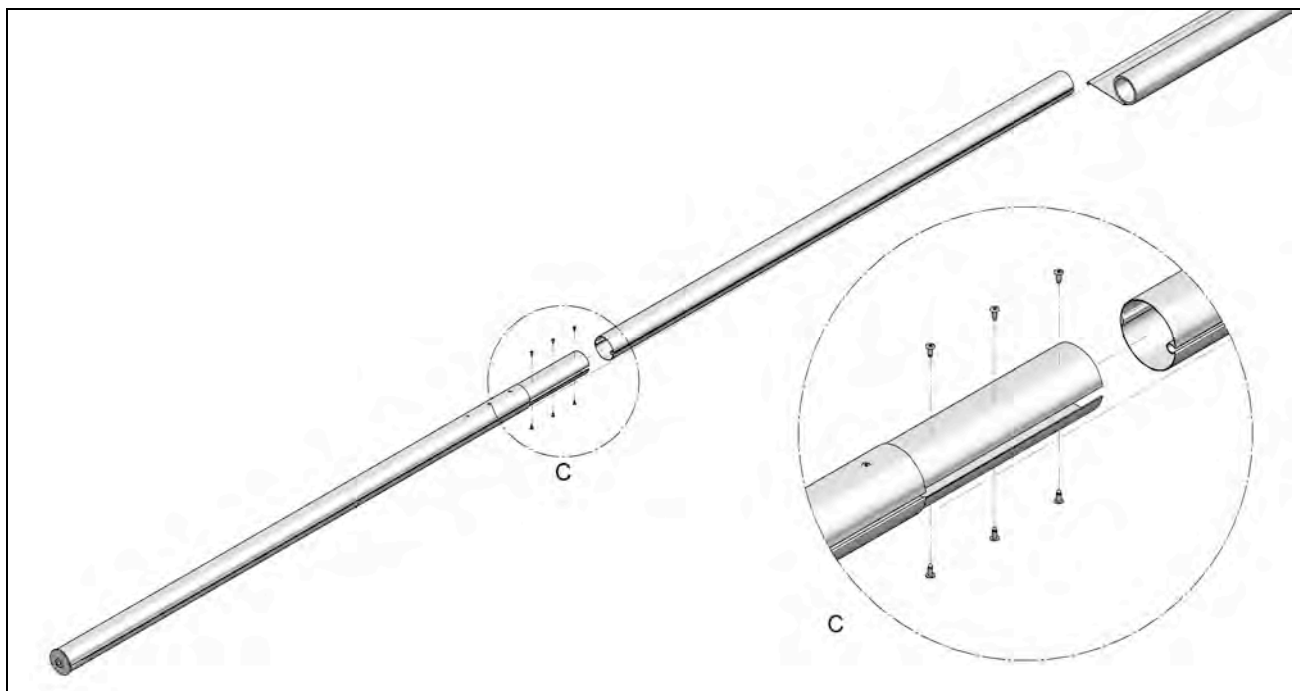

WARNING: Couple the tube by inserting it on the pre-assembled joint and secure with the rivets provided.

WARNING: Slide the fabric into the tube, centre, and lock it.

FABRIC ROLLING

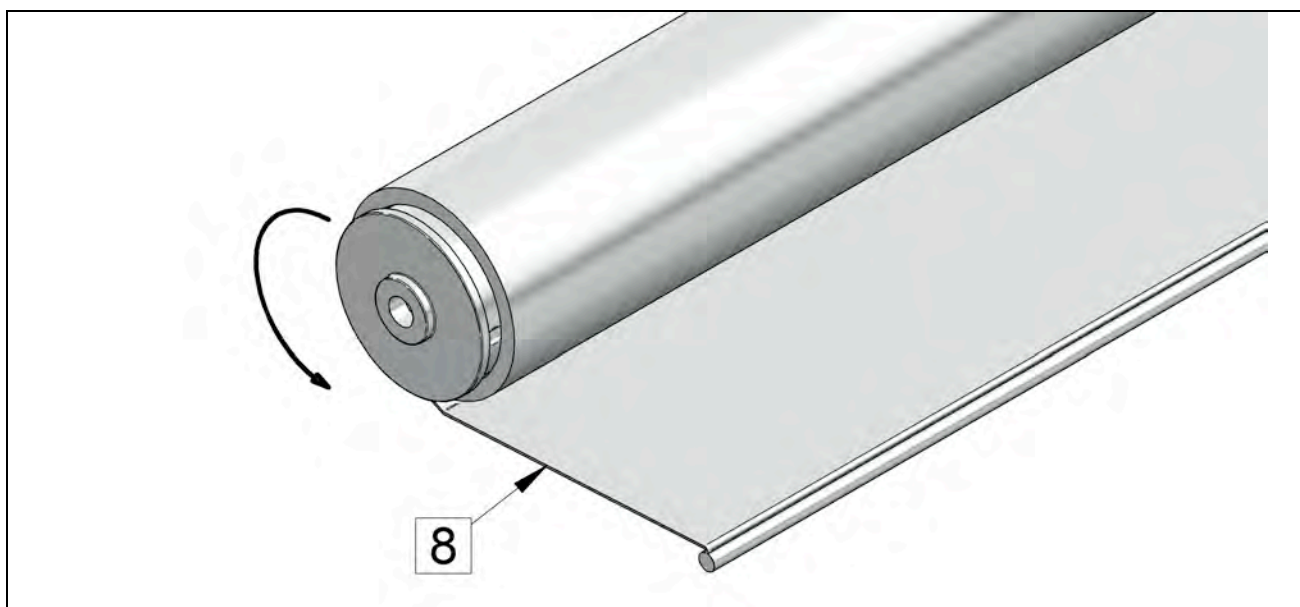

WARNING: Roll up the fabric on the roller tube.

WARNING: Be careful with the fabric rolling direction; the fabric must always run at the underneath (ref.8).



ASSEMBLING ROLLER TUBE/FABRIC

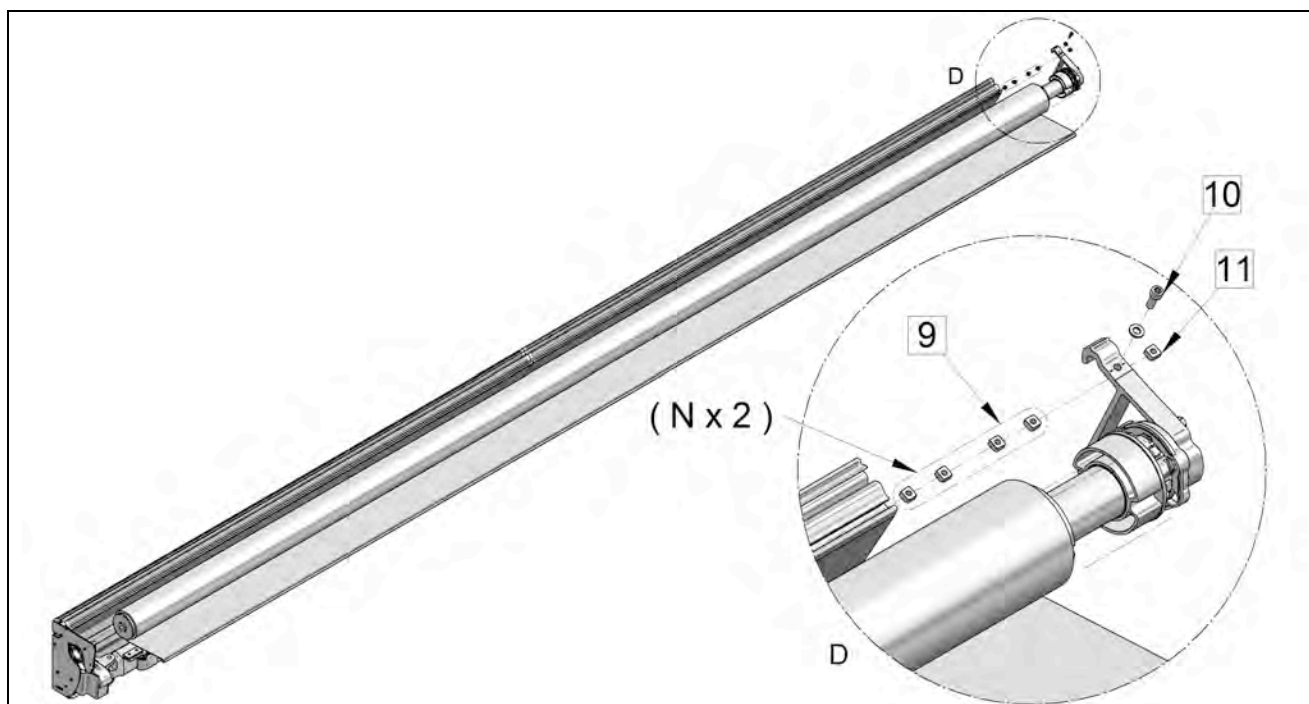

WARNING: Insert the cover profile supports square nuts (ref. 9) (No 2 nuts for each cover profile support).

WARNING: Insert the motor, previously fit onto the roller support, into the roller tube assembly.

WARNING: Insert the tube onto the plate with pin; on the motor side, fix the roller tube support with the M6x16 screw (ref.10) onto the square nut (ref.11) inserted into the cassette (allen wrench 5).

COUPLING SADDLE PROFILE

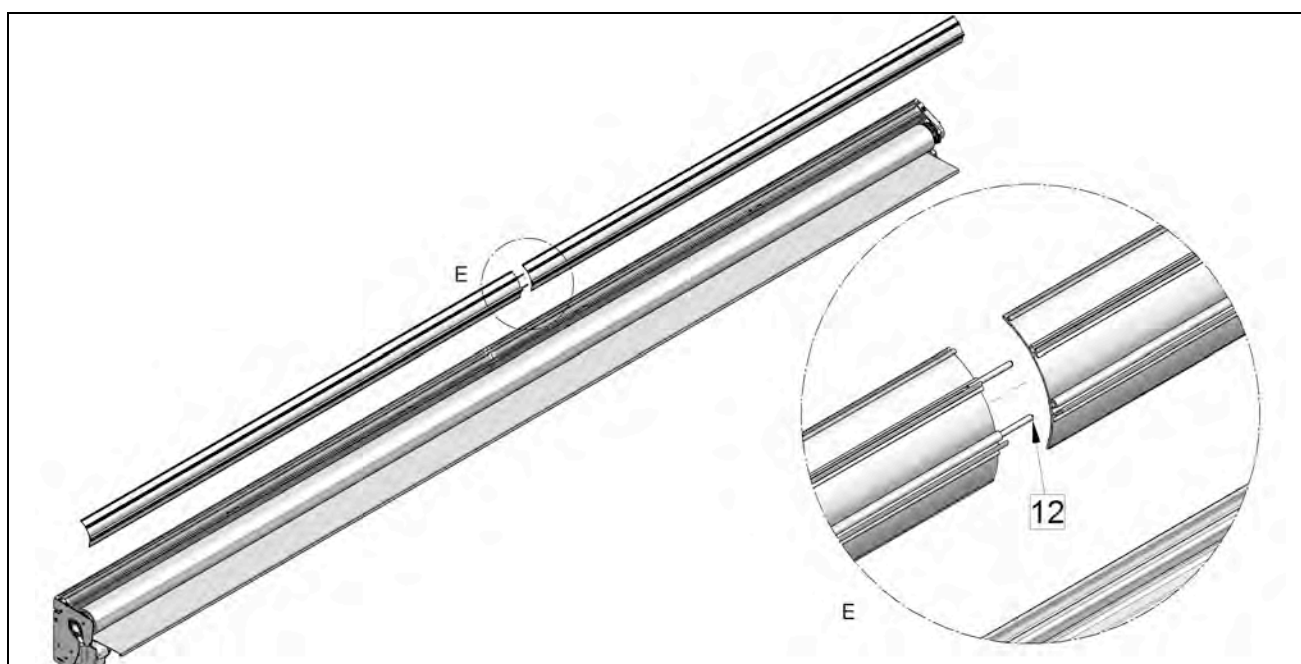

WARNING: Couple the two saddle profiles using the plugs (ref. 12).



PLACING SELF-LUBRICATING TAPES

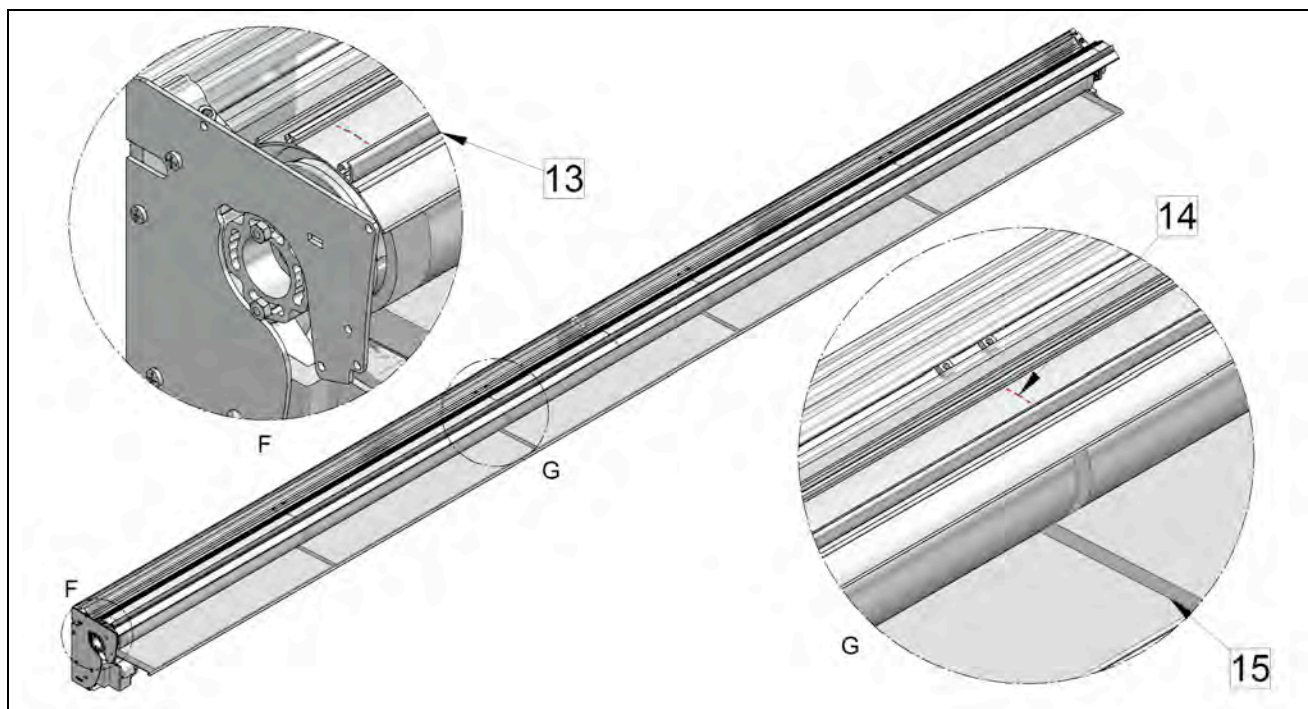

WARNING: Place the saddle profile (ref. 13) above the fabric and align it to the cassette.

WARNING: Mark all stitchings (ref. 15) on the saddle profile (ref. 14).

FITTING SELF-LUBRICATING TAPES

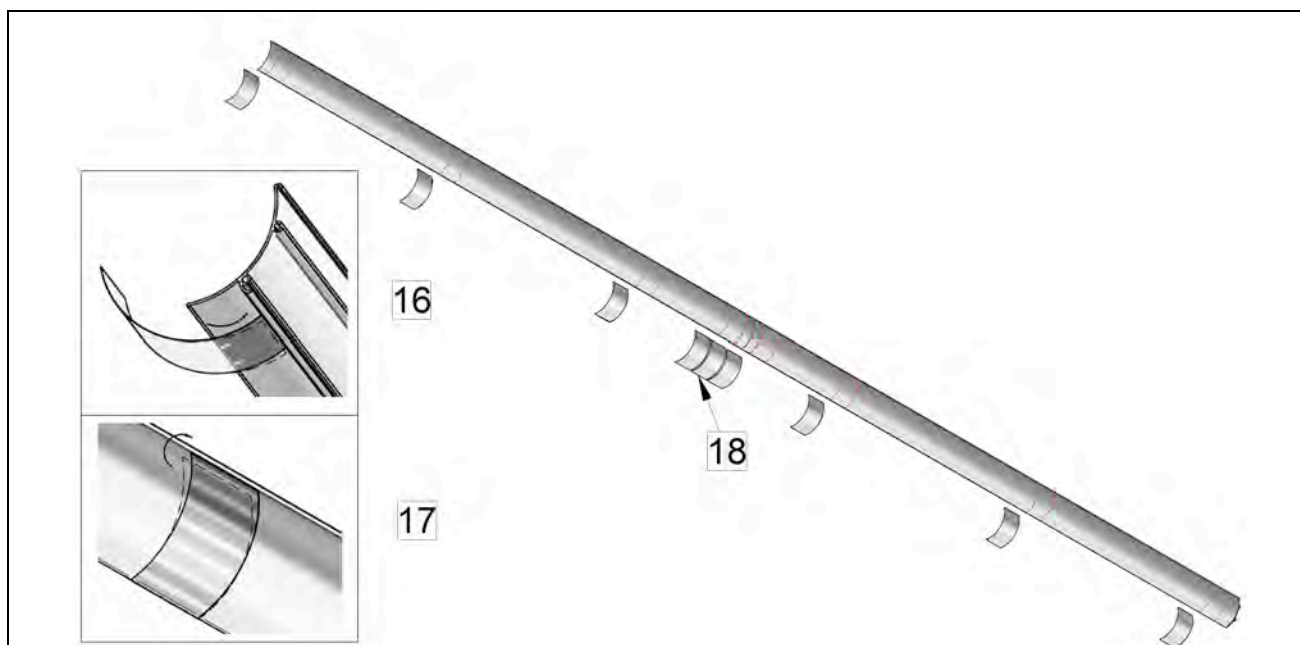

WARNING: Clean and prime the saddle profile surface on both sides, where the self-lubricating tapes will be placed- in correspondence of the stitching marks.

WARNING: The tapes should be applied first on the outer side (ref. 16) and then on the inside (ref. 17), making sure they adhere correctly.

WARNING: In the central part, one tape must be applied on the joint (ref. 18) and one next to it on both sides.



FITTING COVER PROFILE SUPPORTS



WARNING: Insert all cover profile supports onto the saddle profile.

COUPLING SADDLE /CASSETTE PROFILES

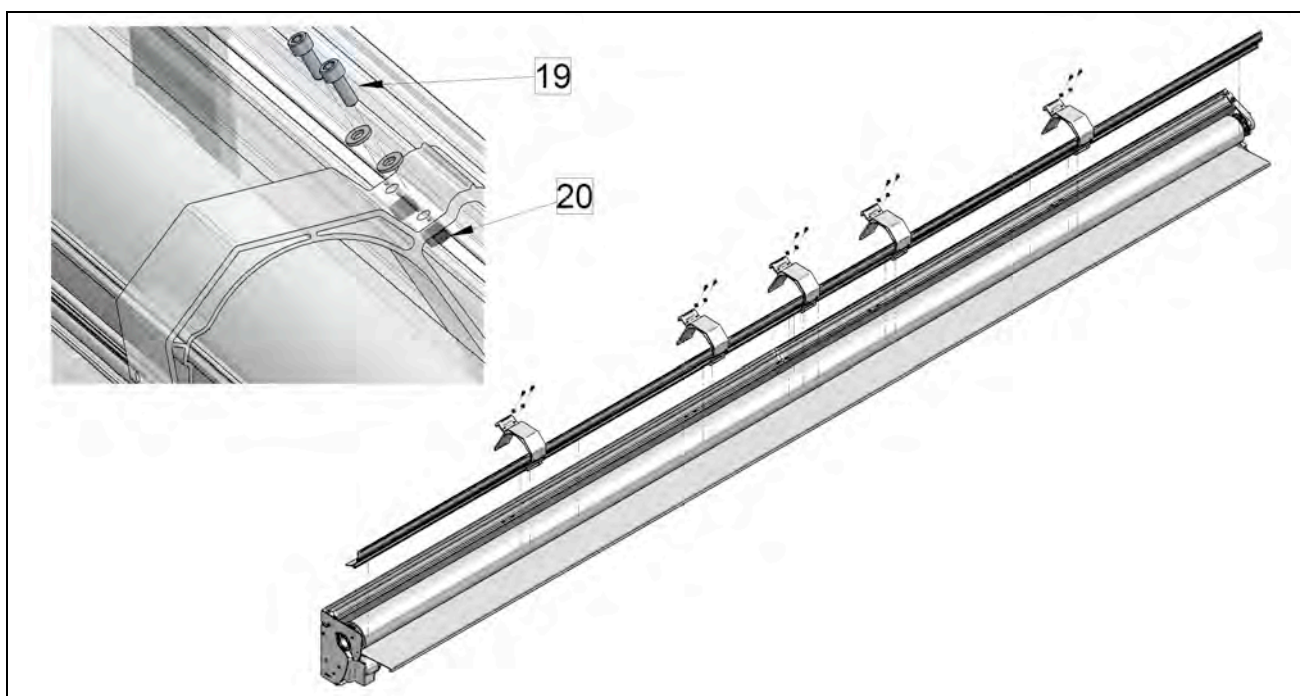

WARNING: Insert the saddle profile along with the cover profile supports on the cassette; for projections higher than 3 m, partly unroll the fabric.

WARNING: insert the M6x16 screws (ref. 19) into the corresponding square nuts (ref. 20)

FIXING SADDLE PROFILE

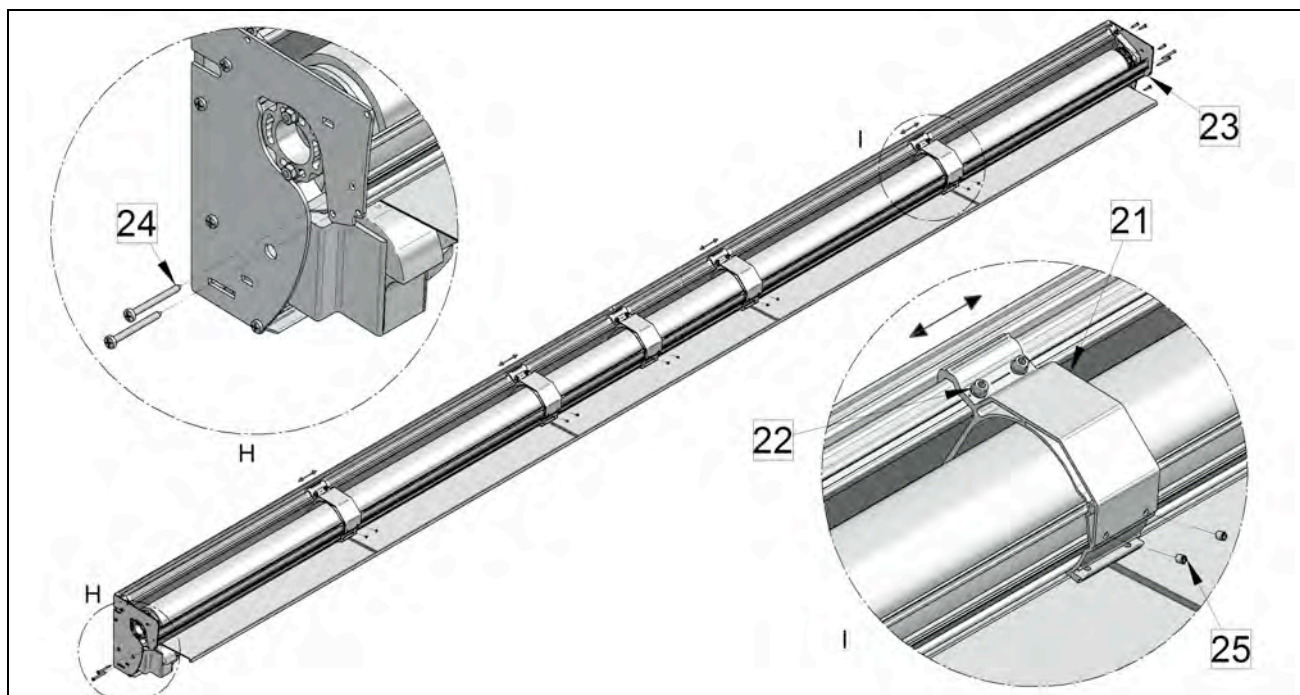

WARNING: Place the cover profile supports (ref. 21) in correspondence of the stitchings and one in the centre; secure with the M6 screw (ref. 22) previously inserted (allen wrench 5).

WARNING: Fit the end plate (ref. 23) to the cassette, making sure the L50 self-tapping screws (ref. 24) are inserted into the saddle profile.

WARNING: Slightly tighten the M6 dowels (ref.25) onto the cover profile supports, just enough to adjust the tightness between cover profile support and saddle profile (allen wrench 3).

COUPLING COVER PROFILE

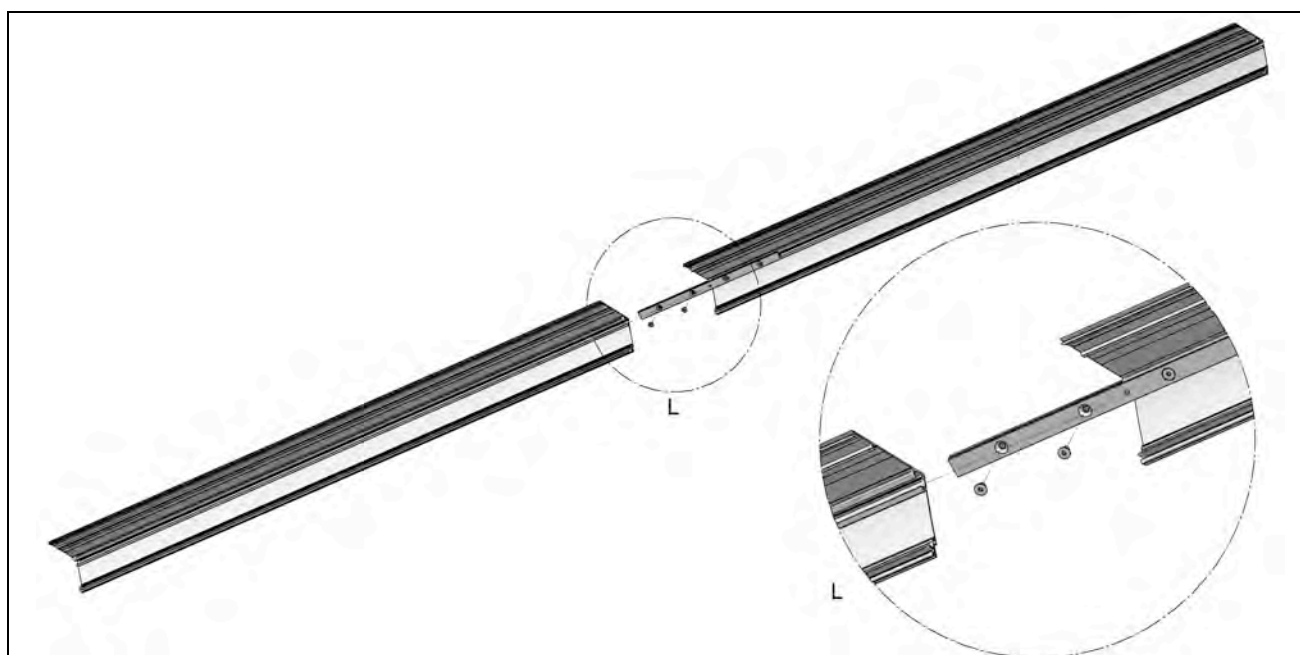

WARNING: Insert the cover profile onto the pre-assembled joint and fix the M6 countersunk screws (allen wrench 5).



FIXING COVER PROFILE

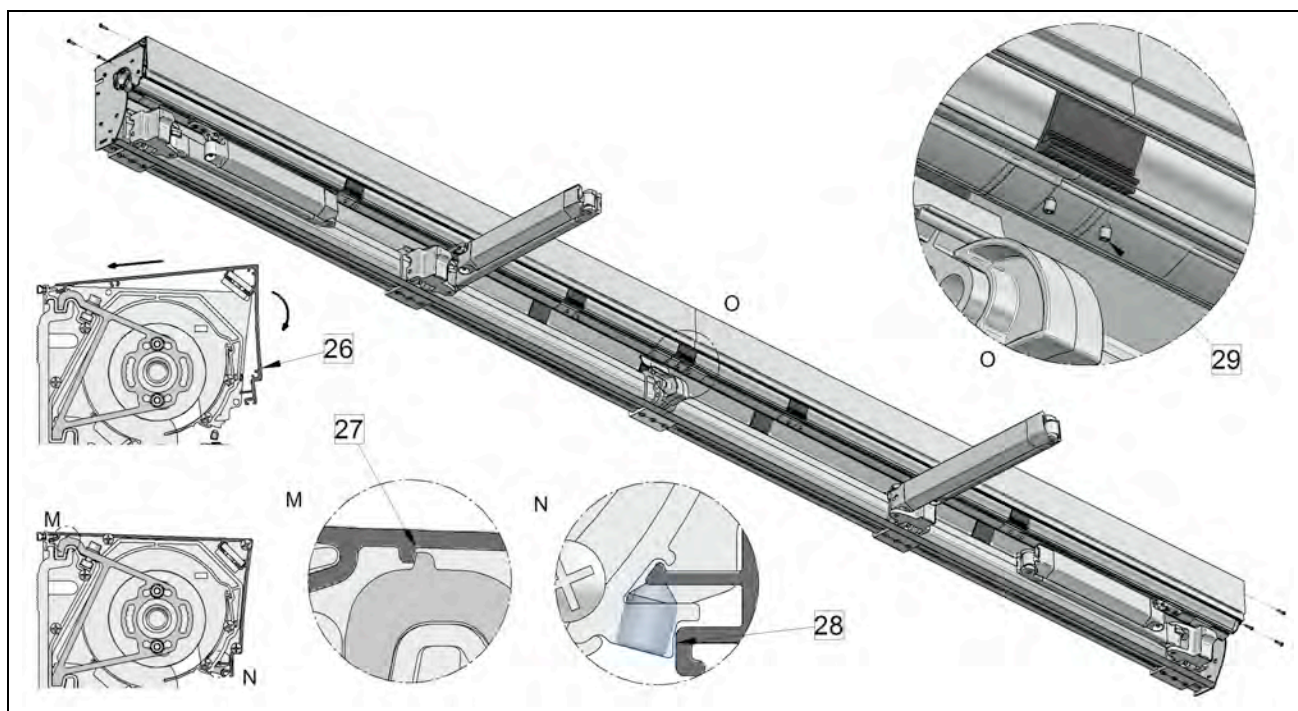

WARNING: Insert the cover profile (ref.26) making sure the front profile tooth is positioned in front of the supports tooth (ref. 27) and the front part matches the cover profile support (ref. 28).

WARNING: Secure the cover profile with the side screws and the cover supports M6 dowels (ref. 29) (allen wrench 3); to carry out this operation, the arms should be displaced.

TERMINAL PROFILE COUPLING

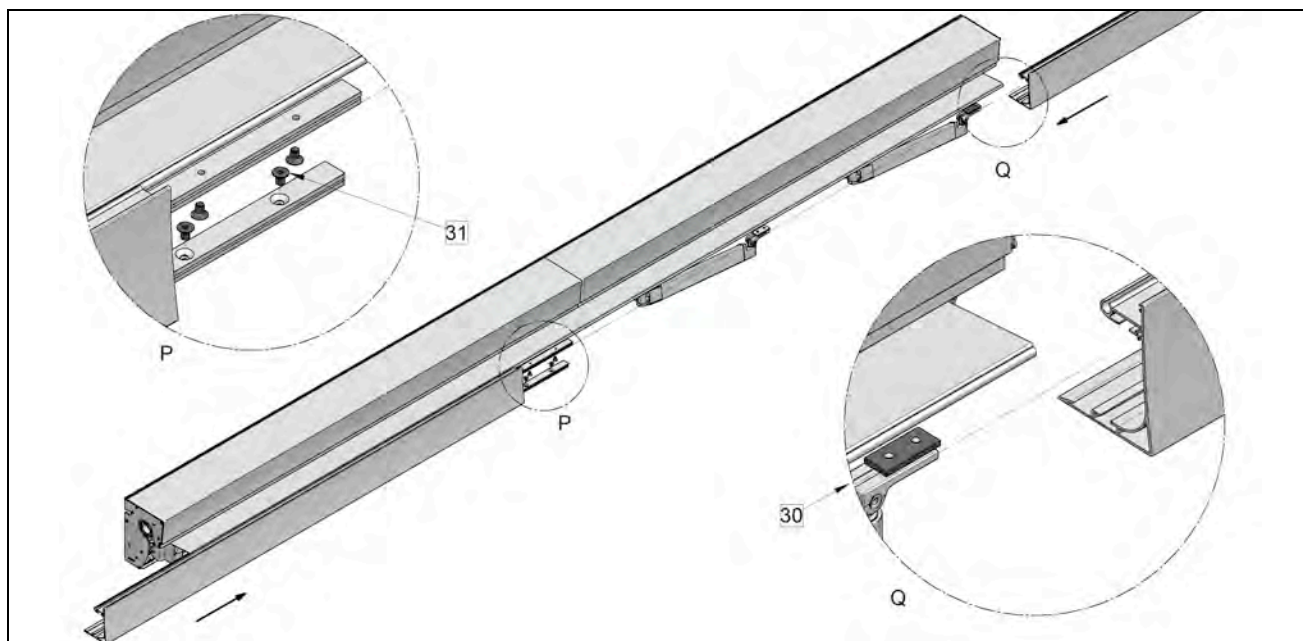

WARNING: Slide the terminal profiles into the fabric and the terminal bar connecting plates (ref. 30) on both sides.

WARNING: Couple the profiles with the pre-assembled joints (ref. 31) tightening the M6 countersunk screws (allen wrench 5).



FITTING TERMINAL CONVOYER

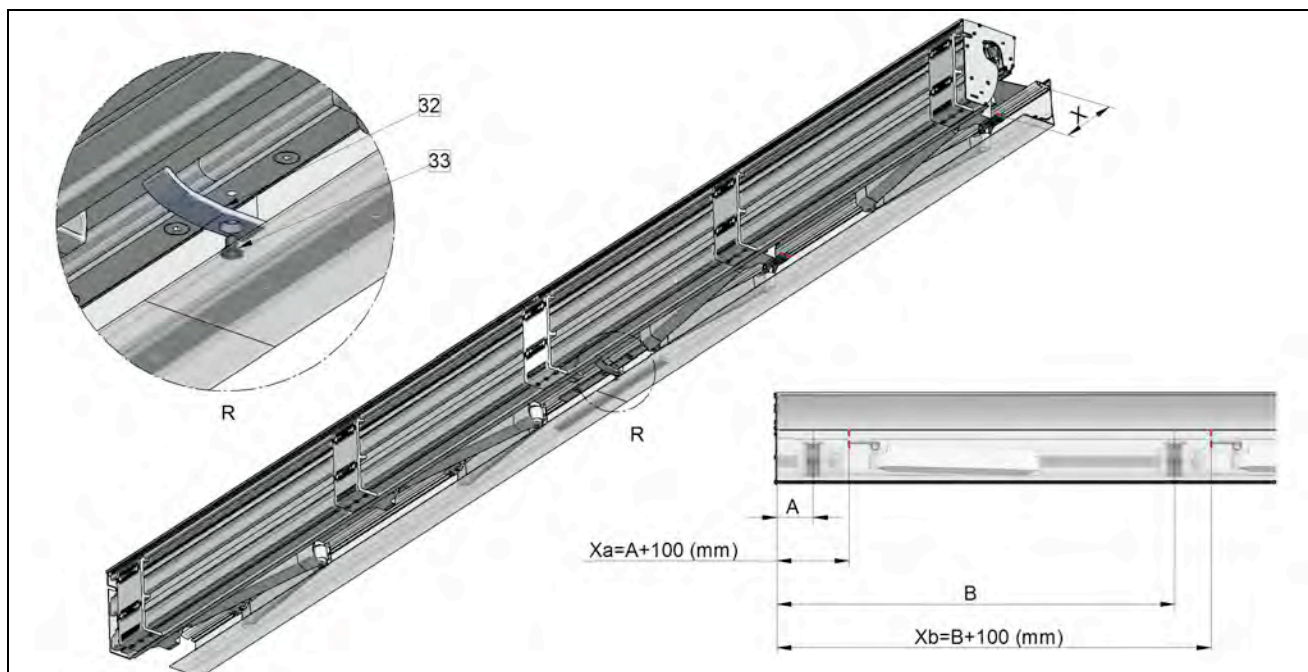

WARNING: Fit the convoyer (ref. 32) at the centre of the terminal bar top joint with the M8 countersunk screw (ref. 33) (allen wrench 5).

WARNING: Centre the terminal profile with the cassette; keeping the arms aligned, fully tighten the terminal bar connectors screws into position as shown in the drawing.

INSERTING GASKET AND BRUSH

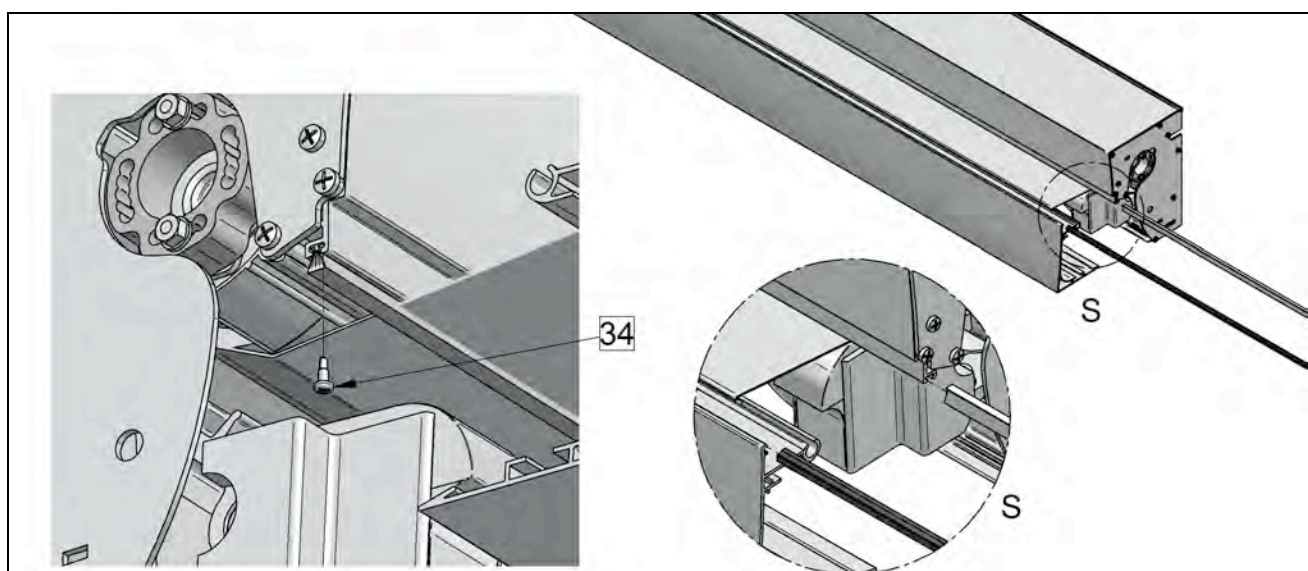

WARNING: Insert the gasket into the terminal bar and the brush into the cover profile; secure the latter with the self-drilling screw on both ends (ref. 34).



INSERTING END COVERS

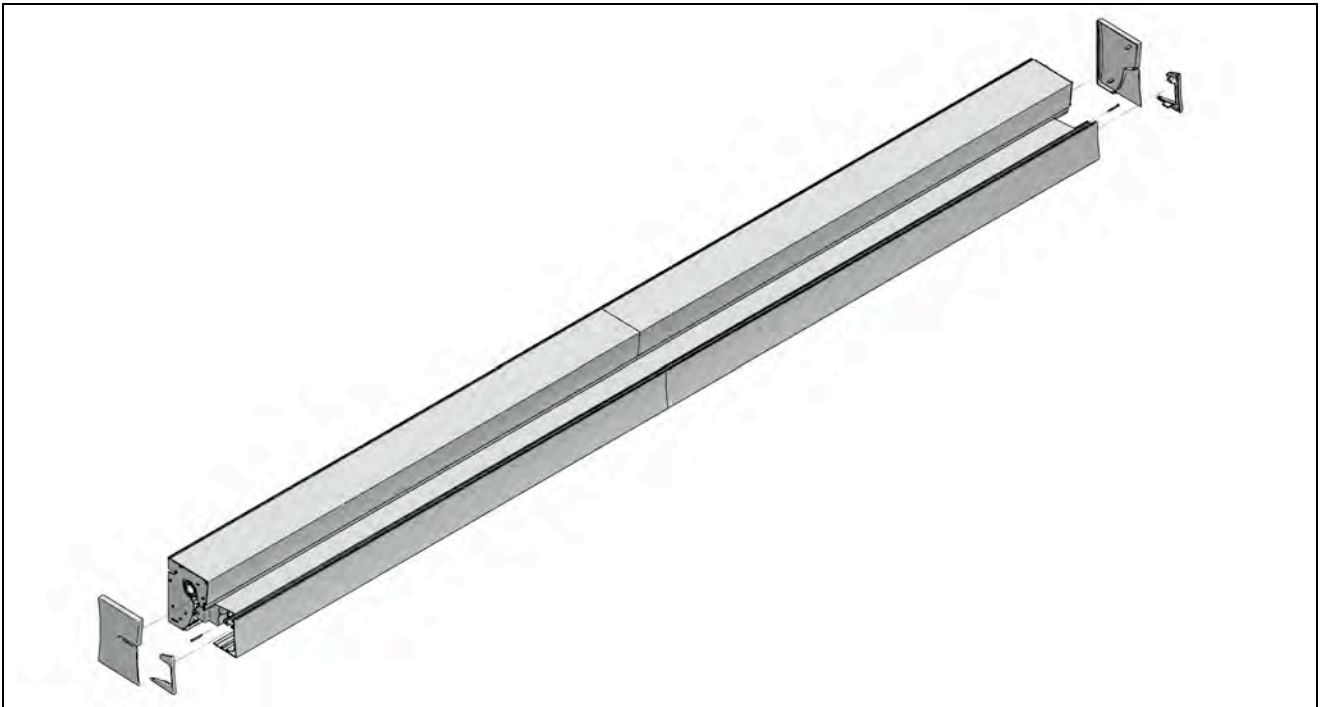

WARNING: After checking that the arms are aligned, and the terminal bar is centred, lock the fabric and insert the terminal bar end caps and the cassette end covers.

WARNING: For the awning adjustment please refer to the standard installation manual.

NOTES

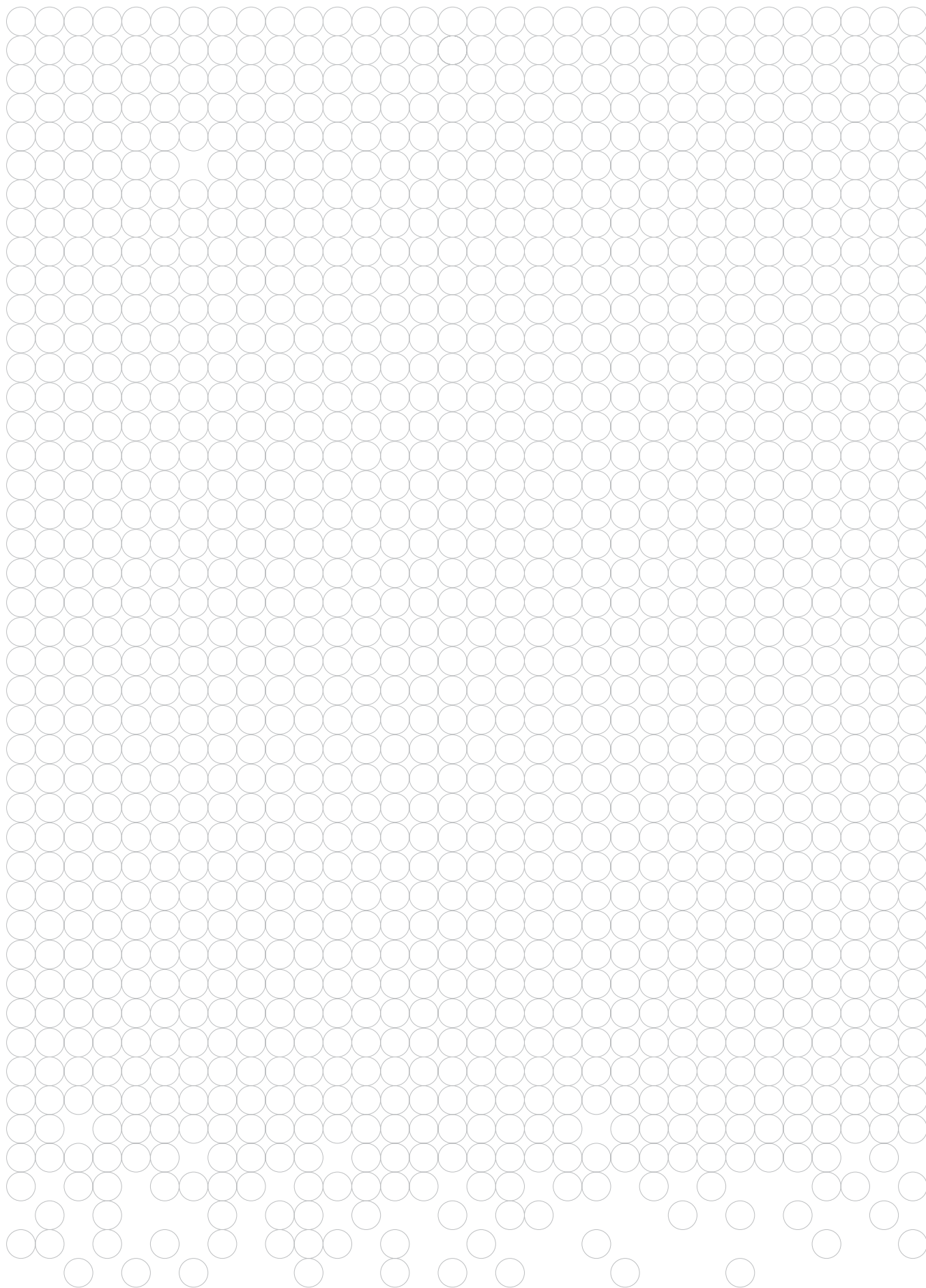

NOTES

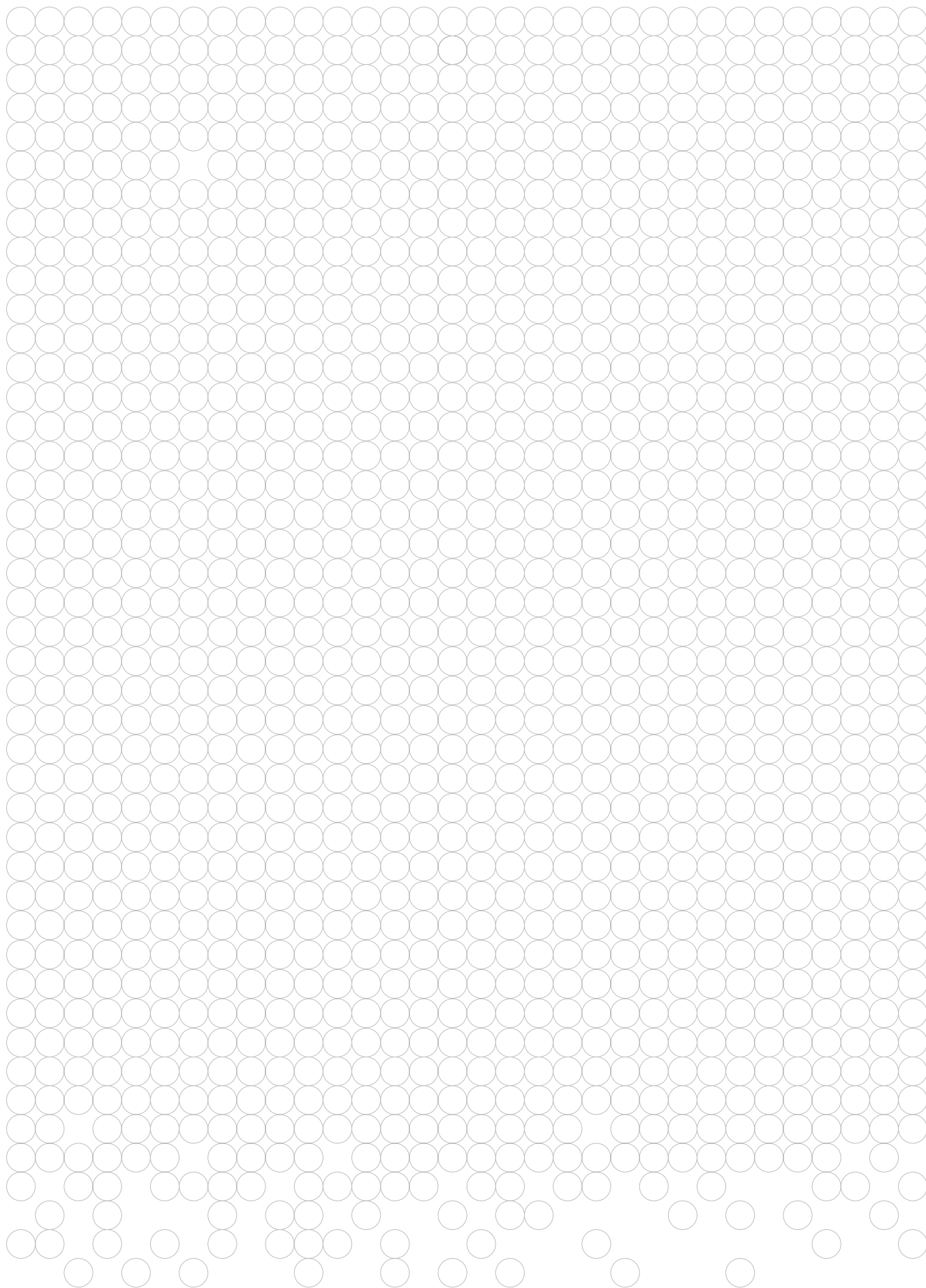

Art direction **UbisThree**

Last revision: 05.2017



via Lazio, 42
31045 Motta di Livenza (TV) - Italy

t: +39 0422 1786080
f: +39 0422 1788073

info@shadelab.it
www.shadelab.it